

## G ELECTRICAL WIRING ROUTING

### Position of Parts in Engine Compartment

[Access Cab, Standard Cab : 2UZ-FE]

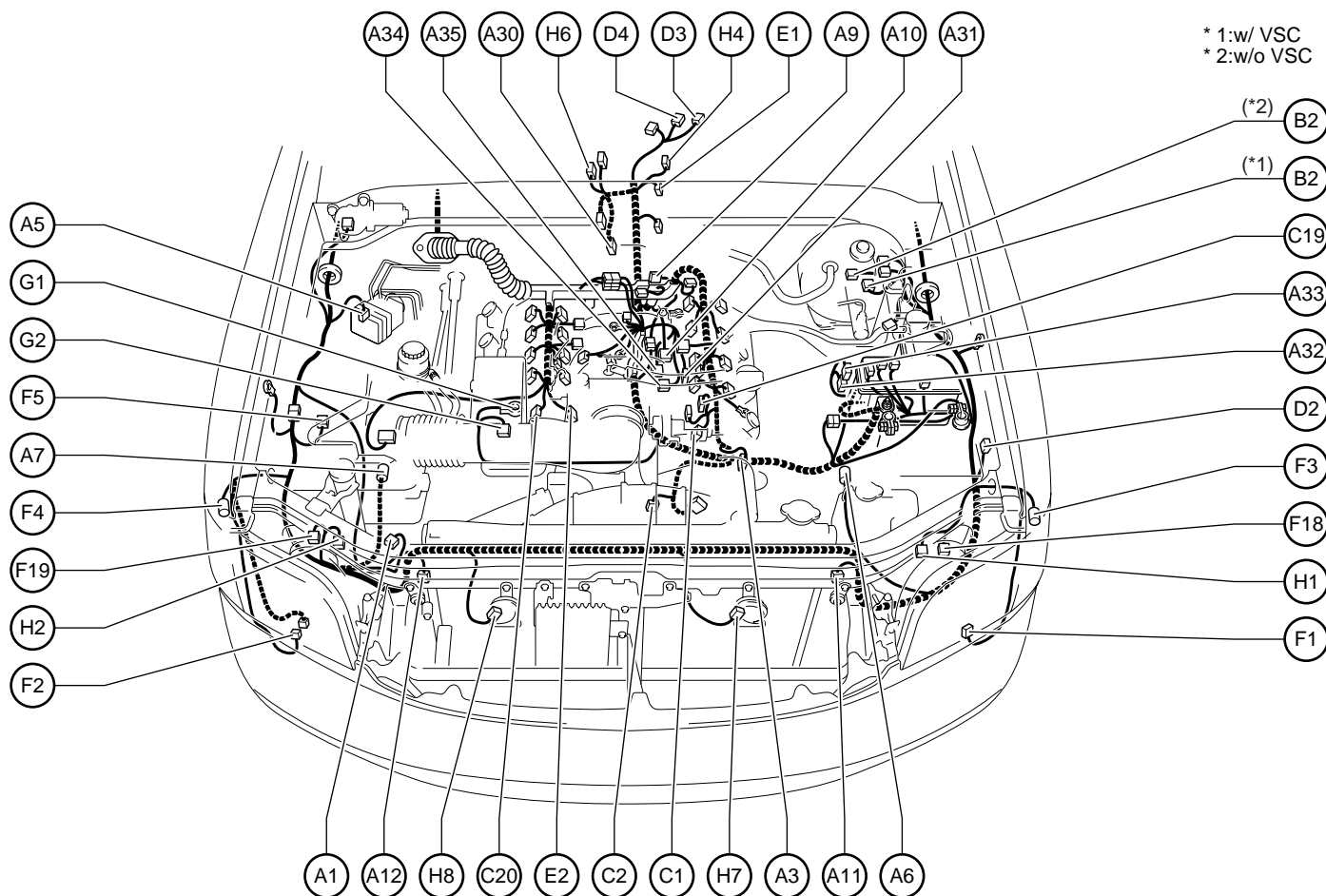

A 1 Pressure SW  
 A 3 A/C Magnetic Clutch and Lock Sensor  
 A 5 ABS Actuator with ECU  
 A 6 ABS Speed Sensor Front LH  
 A 7 ABS Speed Sensor Front RH  
 A 9 ADD Actuator  
 A10 Air Fuel Ratio Sensor (Bank 1 Sensor 1)  
 A11 Airbag Sensor Front LH  
 A12 Airbag Sensor Front RH  
 A30 Air Fuel Ratio Sensor (Bank 2 Sensor 1)  
 A31 Air Switching Valve  
 A32 Air Injection Control Driver  
 A33 Air Injection Control Driver  
 A34 Air Pressure Sensor  
 A35 Air Pump

B 2 Brake Fluid Level Warning SW

C 1 Camshaft Position Sensor  
 C 2 Crankshaft Position Sensor  
 C19 Camshaft Timing Oil Control Valve LH  
 C20 Camshaft Timing Oil Control Valve RH

D 2 Daytime Running Light Resistor  
 D 3 Detection SW (Transfer 4WD Position)  
 D 4 Detection SW (Transfer L4 Position)

E 1 Electronically Controlled Transmission Solenoid  
 E 2 Engine Coolant Temp. Sensor

F 1 Front Fog Light LH  
 F 2 Front Fog Light RH  
 F 3 Front Turn Signal Light and Parking Light LH  
 F 4 Front Turn Signal Light and Parking Light RH  
 F 5 Fuel Pump Resistor  
 F18 Front Parking Light LH No.3  
 F19 Front Parking Light RH No.3

G 1 Generator  
 G 2 Generator

H 1 Headlight LH  
 H 2 Headlight RH  
 H 4 Heated Oxygen Sensor (Bank 1 Sensor 2)  
 H 6 Heated Oxygen Sensor (Bank 2 Sensor 2)  
 H 7 Horn LH  
 H 8 Horn RH

## Position of Parts in Engine Compartment

**[Access Cab, Standard Cab : 2UZ-FE]**

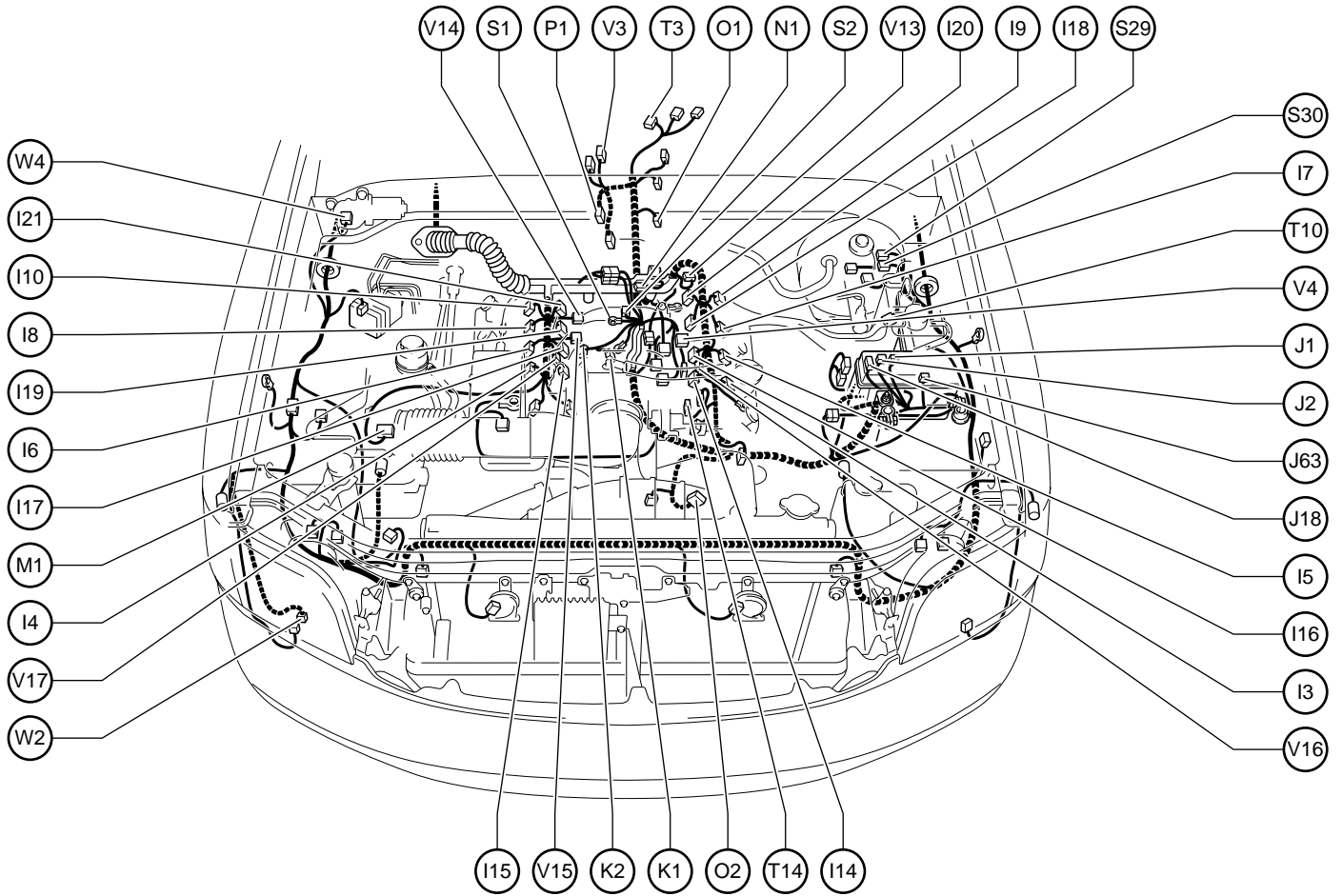

I 3 Igniter and Ignition Coil No.1  
 I 4 Igniter and Ignition Coil No.2  
 I 5 Igniter and Ignition Coil No.3  
 I 6 Igniter and Ignition Coil No.4  
 I 7 Igniter and Ignition Coil No.5  
 I 8 Igniter and Ignition Coil No.6  
 I 9 Igniter and Ignition Coil No.7  
 I 10 Igniter and Ignition Coil No.8  
 I 14 Injector No.1  
 I 15 Injector No.2  
 I 16 Injector No.3  
 I 17 Injector No.4  
 I 18 Injector No.5  
 I 19 Injector No.6  
 I 20 Injector No.7  
 I 21 Injector No.8

J 1 Junction Connector  
 J 2 Junction Connector  
 J 18 Junction Connector  
 J 63 Junction Connector

K 1 Knock Sensor (Bank 1)  
 K 2 Knock Sensor (Bank 2)

M 1 Mass Air Flow Meter

N 1 Noise Filter

O 1 O/D Direct Clutch Speed Sensor  
 O 2 Oil Pressure SW

P 1 Park/Neutral Position SW

S 1 Starter  
 S 2 Starter  
 S29 Skid Control ECU with Actuator  
 S30 Skid Control ECU with Actuator

T 3 Transfer Shift Actuator  
 T 10 TVIP Buzzer  
 T 14 Throttle Control Motor and Throttle Position Sensor

V 3 Vehicle Speed Sensor  
 (Electronically Controlled Transmission)  
 V 4 VSV (Purge)  
 V13 VSV (ACIS)  
 V14 VSV (Air Switching Valve Bank 1)  
 V15 VSV (Air Switching Valve Bank 2)  
 V16 VVT Sensor LH  
 V17 VVT Sensor RH

W 2 Washer Motor and Washer Level Sensor  
 W 4 Wiper Motor

## G ELECTRICAL WIRING ROUTING

### Position of Parts in Engine Compartment

[Access Cab, Standard Cab : 1GR-FE]

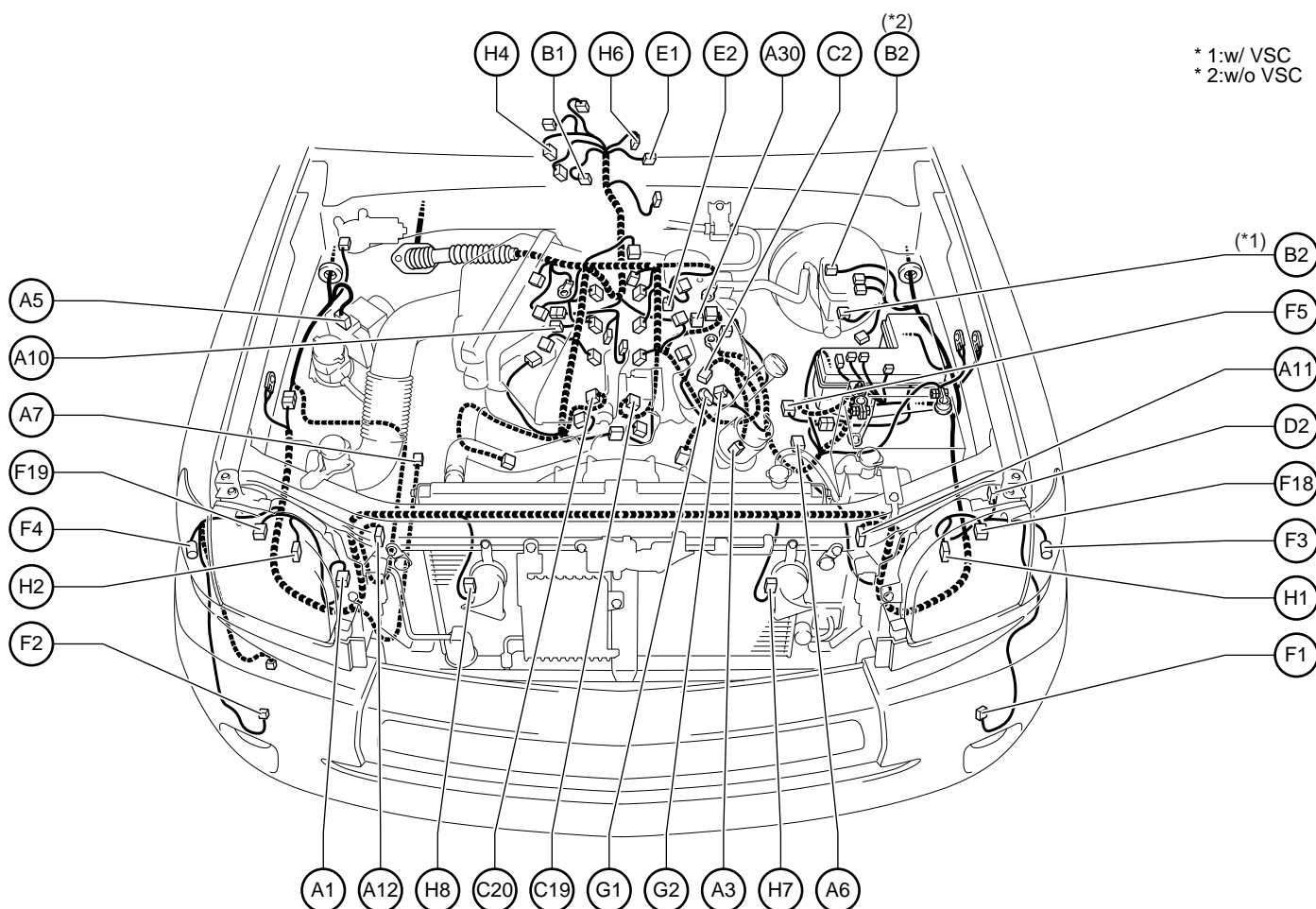

\* 1:w/ VSC  
\* 2:w/o VSC

A 1 Pressure SW  
A 3 A/C Magnetic Clutch and Lock Sensor  
A 5 ABS Actuator with ECU  
A 6 ABS Speed Sensor Front LH  
A 7 ABS Speed Sensor Front RH  
A10 Air Fuel Ratio Sensor (Bank 1 Sensor 1)  
A11 Airbag Sensor Front LH  
A12 Airbag Sensor Front RH  
A30 Air Fuel Ratio Sensor (Bank 2 Sensor 1)

B 1 Back-Up Light SW  
B 2 Brake Fluid Level Warning SW

C 2 Crankshaft Position Sensor  
C19 Camshaft Timing Oil Control Valve LH  
C20 Camshaft Timing Oil Control Valve RH

D 2 Daytime Running Light Resistor

E 1 Electronically Controlled Transmission Solenoid  
E 2 Engine Coolant Temp. Sensor

F 1 Front Fog Light LH  
F 2 Front Fog Light RH  
F 3 Front Turn Signal Light and Parking Light LH  
F 4 Front Turn Signal Light and Parking Light RH  
F 5 Fuel Pump Resistor  
F18 Front Parking Light LH No.3  
F19 Front Parking Light RH No.3

G 1 Generator  
G 2 Generator

H 1 Headlight LH  
H 2 Headlight RH  
H 4 Heated Oxygen Sensor (Bank 1 Sensor 2)  
H 6 Heated Oxygen Sensor (Bank 2 Sensor 2)  
H 7 Horn LH  
H 8 Horn RH

## Position of Parts in Engine Compartment

**[Access Cab, Standard Cab : 1GR-FE]**

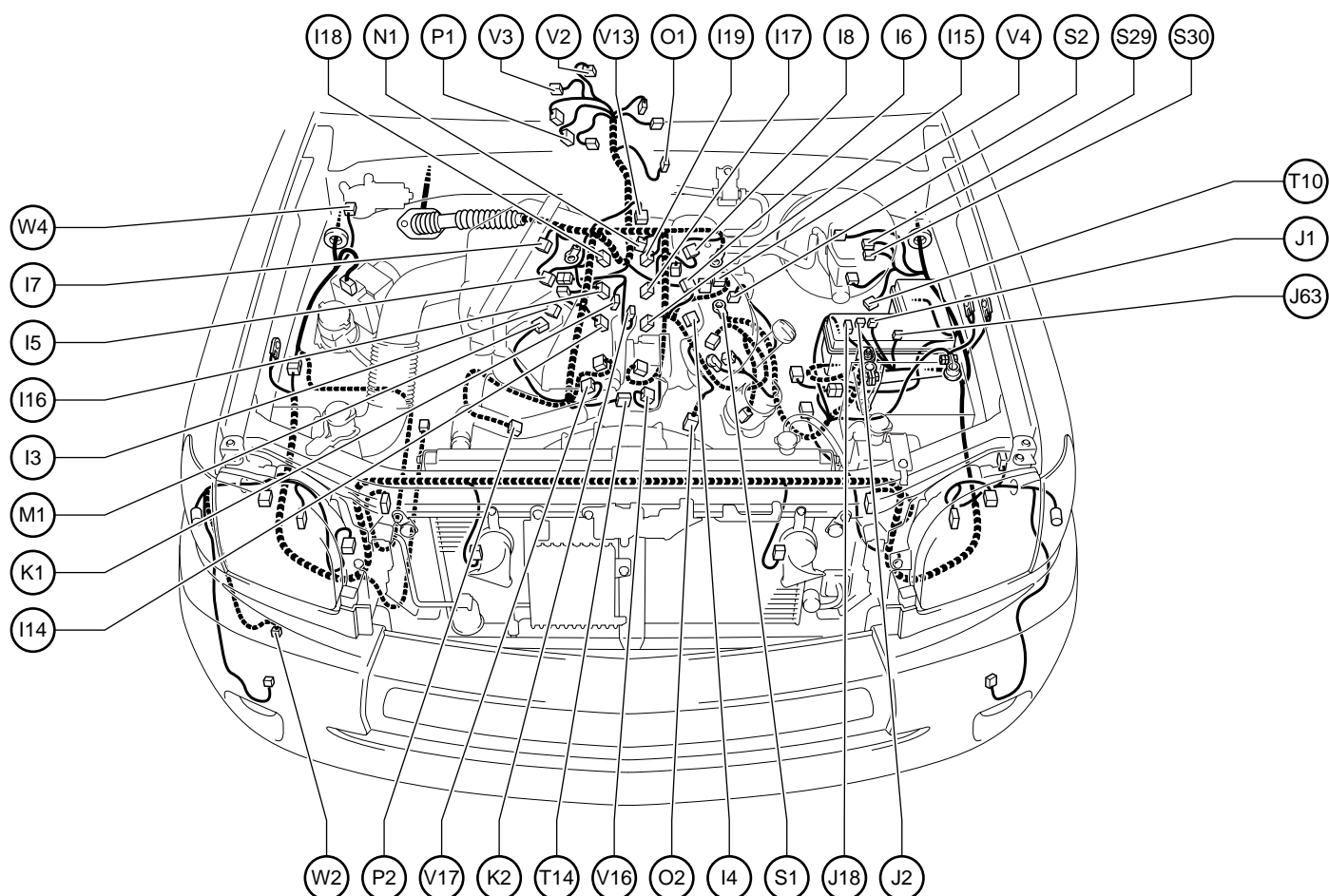

I 3 Igniter and Ignition Coil No.1  
 I 4 Igniter and Ignition Coil No.2  
 I 5 Igniter and Ignition Coil No.3  
 I 6 Igniter and Ignition Coil No.4  
 I 7 Igniter and Ignition Coil No.5  
 I 8 Igniter and Ignition Coil No.6  
 I 14 Injector No.1  
 I 15 Injector No.2  
 I 16 Injector No.3  
 I 17 Injector No.4  
 I 18 Injector No.5  
 I 19 Injector No.6

J 1 Junction Connector  
 J 2 Junction Connector  
 J 18 Junction Connector  
 J 63 Junction Connector

K 1 Knock Sensor (Bank 1)  
 K 2 Knock Sensor (Bank 2)

M 1 Mass Air Flow Meter

N 1 Noise Filter

O 1 O/D Direct Clutch Speed Sensor  
 O 2 Oil Pressure SW

P 1 Park/Neutral Position SW  
 P 2 Power Steering Oil Pressure SW

S 1 Starter  
 S 2 Starter  
 S29 Skid Control ECU with Actuator  
 S30 Skid Control ECU with Actuator

T 10 TVIP Buzzer  
 T 14 Throttle Control Motor and Throttle Position Sensor

V 2 Vehicle Speed Sensor (Combination Meter)  
 V 3 Vehicle Speed Sensor  
 (Electronically Controlled Transmission)  
 V 4 VSV (Purge)  
 V13 VSV (ACIS)  
 V16 VVT Sensor LH  
 V17 VVT Sensor RH

W 2 Washer Motor and Washer Level Sensor  
 W 4 Wiper Motor

## G ELECTRICAL WIRING ROUTING

### Position of Parts in Instrument Panel

[Access Cab, Standard Cab]

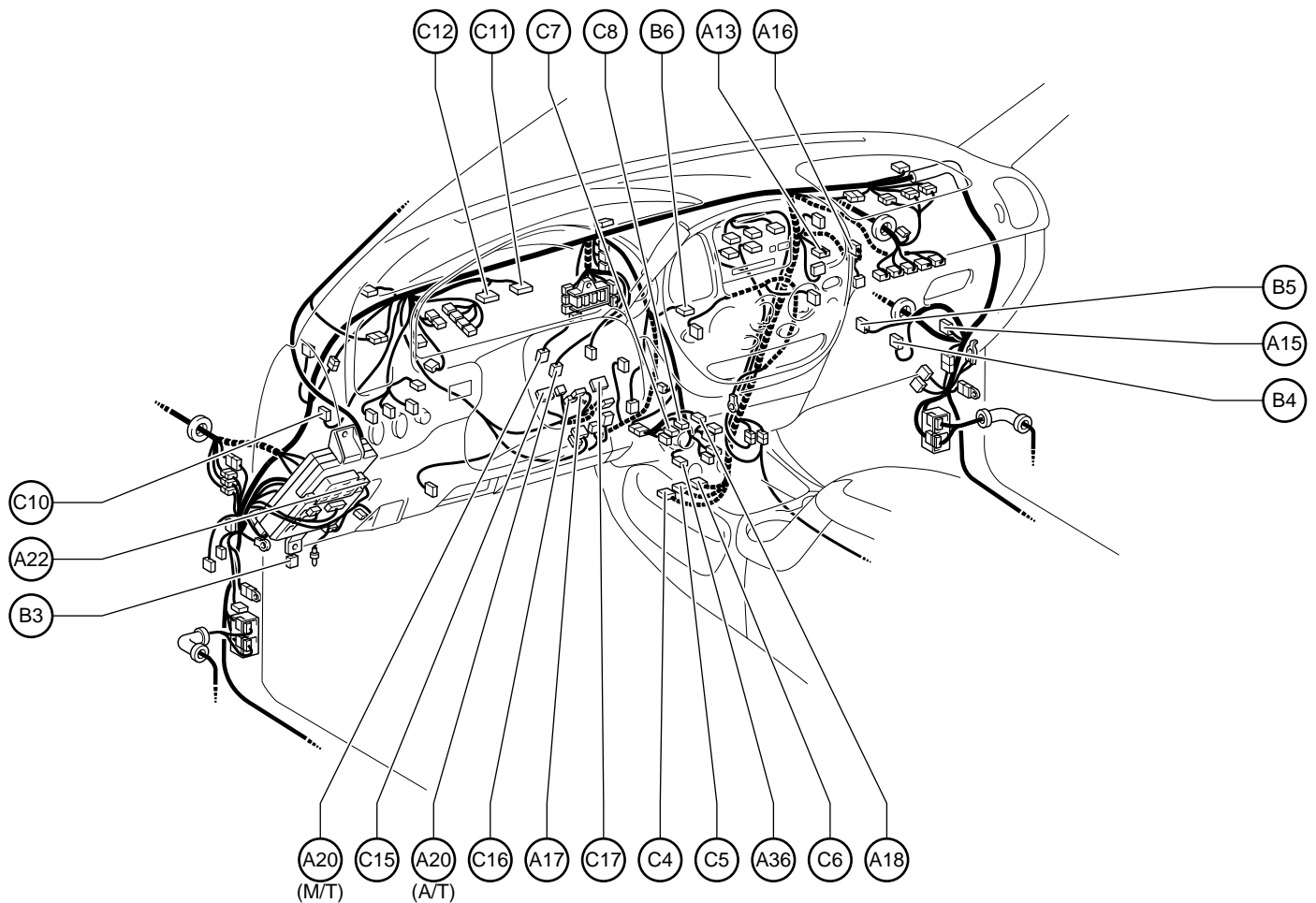

A 13 A/C Thermistor  
 A 15 Air Inlet Control Servo Motor  
 A 16 Airbag Squib (Front Passenger Airbag Assembly)  
 A 17 Airbag Squib (Steering Wheel Pad)  
 A 18 Ashtray Illumination  
 A 20 Accelerator Pedal Position Sensor  
 A 22 ACC Cut Relay  
 A 36 Airbag Cut Off SW

B 3 Back-Up Light Relay  
 B 4 Blower Motor  
 B 5 Blower Resistor  
 B 6 Blower SW and Defroster Mode SW

C 4 Center Airbag Sensor Assembly  
 C 5 Center Airbag Sensor Assembly  
 C 6 Center Airbag Sensor Assembly  
 C 7 Cigarette Lighter  
 C 8 Cigarette Lighter Illumination  
 C 10 Clutch Start Cancel SW  
 C 11 Combination Meter  
 C 12 Combination Meter  
 C 15 Combination SW  
 C 16 Combination SW  
 C 17 Combination SW



## Position of Parts in Instrument Panel

[Access Cab, Standard Cab]

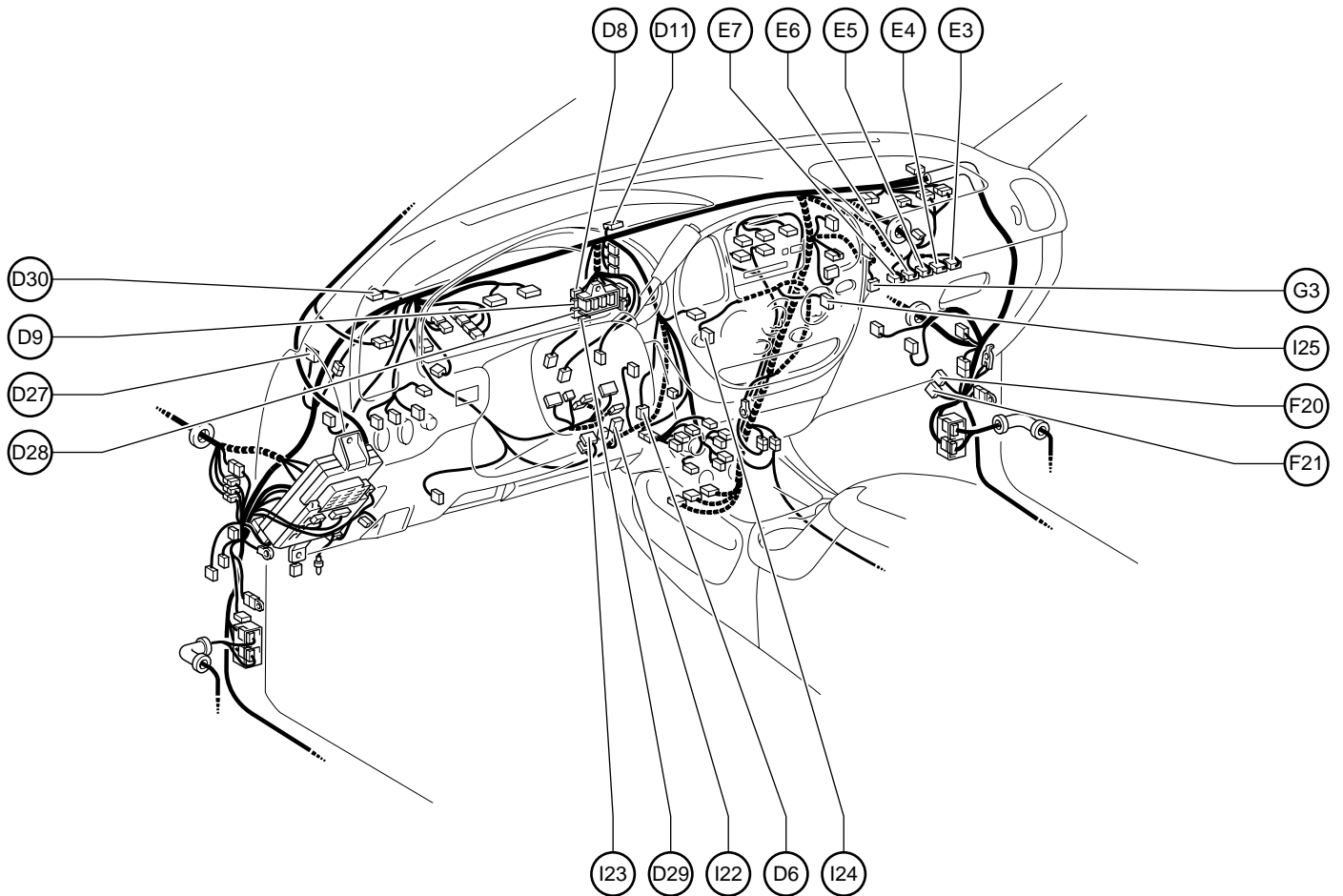

D 6 Data Link Connector 3  
 D 8 Diode (A/T)  
 D 9 Diode (Door Courtesy)  
 D 11 Diode (Power Window System)  
 D 27 Diode (Step Light)  
 D 28 Diode (Door Lock)  
 D 29 Diode (TVIP)  
 D 30 Diode (Unlock Warning)

E 3 Engine Control Module  
 E 4 Engine Control Module  
 E 5 Engine Control Module  
 E 6 Engine Control Module  
 E 7 Engine Control Module

F 20 4WD Control ECU  
 F 21 4WD Control ECU

G 3 Glove Box Light

I 22 Ignition Key Cylinder Light  
 I 23 Ignition SW  
 I 24 Integration Control and Panel  
 I 25 Integration Control and Panel

## G ELECTRICAL WIRING ROUTING

### Position of Parts in Instrument Panel

#### [Access Cab, Standard Cab]

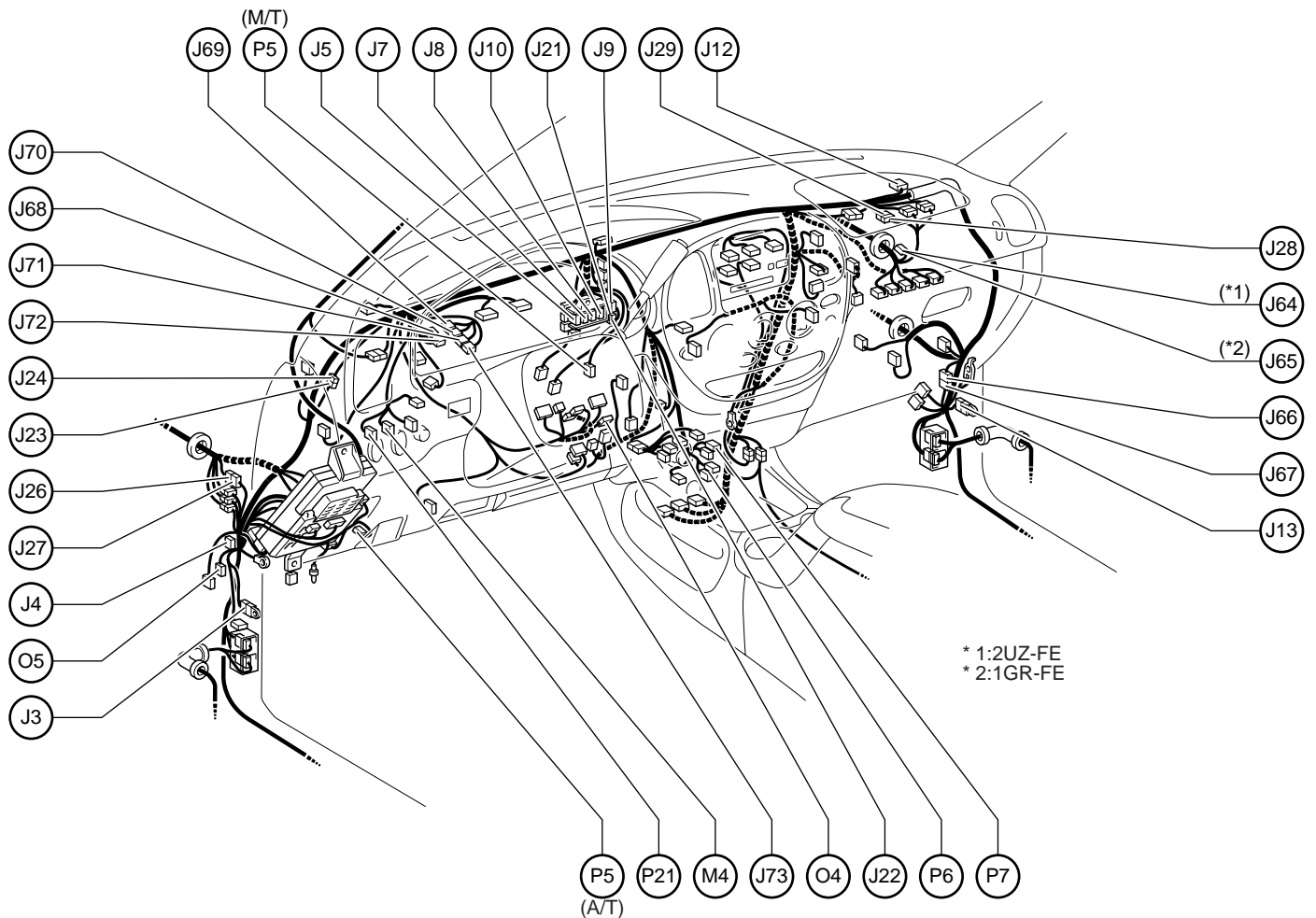

J 3 Junction Connector  
 J 4 Junction Connector  
 J 5 Junction Connector  
 J 7 Junction Connector  
 J 8 Junction Connector  
 J 9 Junction Connector  
 J 10 Junction Connector  
 J 12 Junction Connector  
 J 13 Junction Connector  
 J 21 Junction Connector  
 J 22 Junction Connector  
 J 23 Junction Connector  
 J 24 Junction Connector  
 J 26 Junction Connector  
 J 27 Junction Connector  
 J 28 Junction Connector  
 J 29 Junction Connector  
 J 64 Junction Connector  
 J 65 Junction Connector  
 J 66 Junction Connector  
 J 67 Junction Connector  
 J 68 Junction Connector  
 J 69 Junction Connector  
 J 70 Junction Connector  
 J 71 Junction Connector  
 J 72 Junction Connector  
 J 73 Junction Connector

M 4 Mirror Heater SW  
 O 4 O/D Main SW  
 O 5 Option Connector  
 P 5 Parking Brake SW  
 P 6 Power Outlet  
 P 7 Power Outlet  
 P 21 Power Window Control SW (Back Window)

## Position of Parts in Instrument Panel

### [Access Cab, Standard Cab]

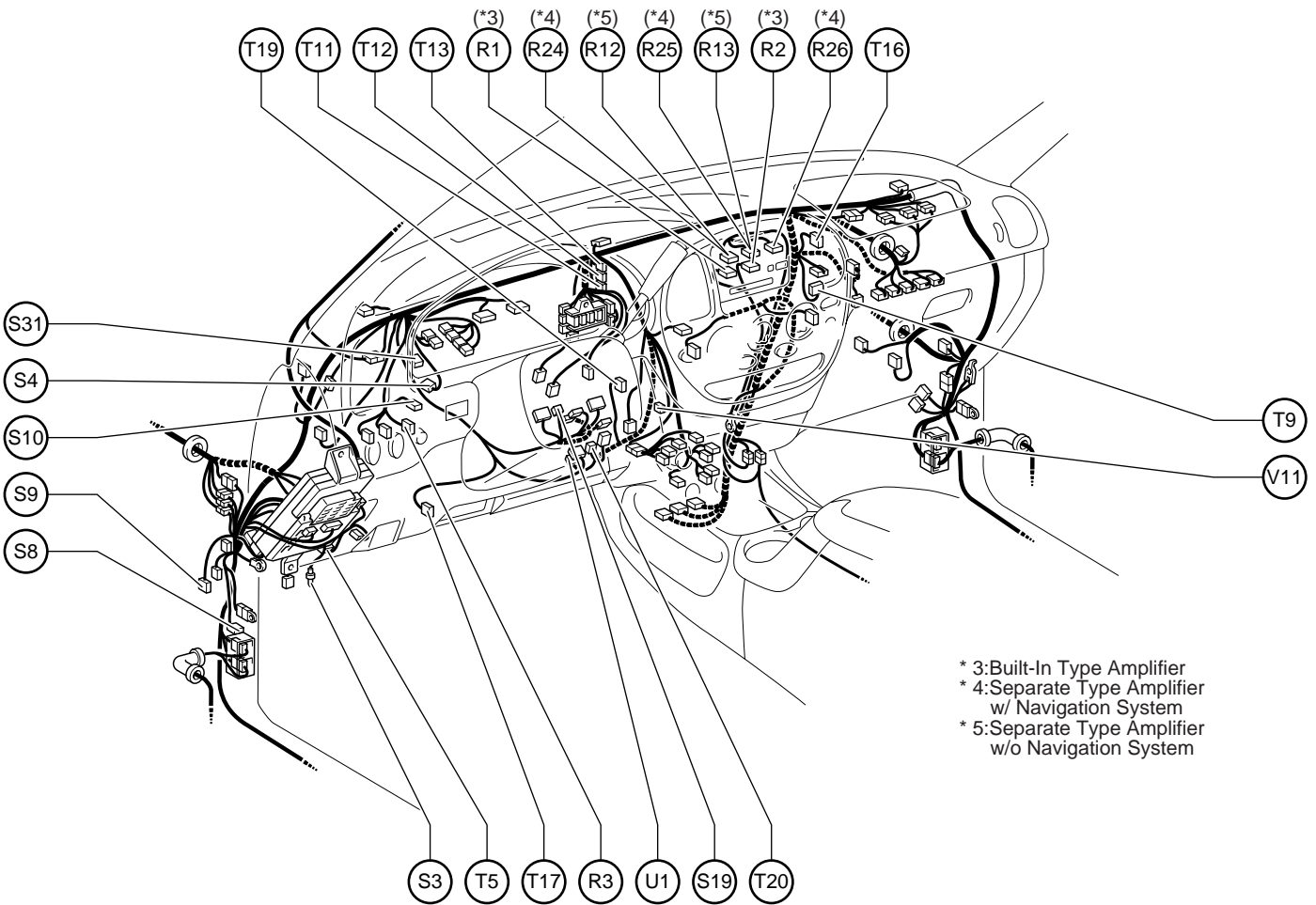

\* 3: Built-In Type Amplifier  
 \* 4: Separate Type Amplifier w/ Navigation System  
 \* 5: Separate Type Amplifier w/o Navigation System

R 1 Radio and Player  
 R 2 Radio and Player  
 R 3 Rheostat  
 R12 Radio and Player  
 R13 Radio and Player  
 R24 Radio and Player with Display  
 R25 Radio and Player with Display  
 R26 Radio and Player with Display

S 3 Step Light  
 S 4 Stop Light SW  
 S 8 Short Pin  
 S 9 Short Connector (TVIP)  
 S10 Security Indicator and Glass Breakage Sensor Microphone  
 S19 Steering Sensor  
 S31 Stop Light Relay

T 5 Turn Signal Flasher  
 T 9 Trailer Converter  
 T11 TVIP ECU  
 T12 TVIP ECU  
 T13 TVIP ECU  
 T16 Tire Pressure Monitor ECU  
 T17 Tire Pressure Warning Standardization SW  
 T19 Transponder Key Computer  
 T20 Transponder Key Amplifier

U 1 Unlock Warning SW  
 V11 VSC Warning Buzzer



## G ELECTRICAL WIRING ROUTING

### Position of Parts in Body

#### [Access Cab]

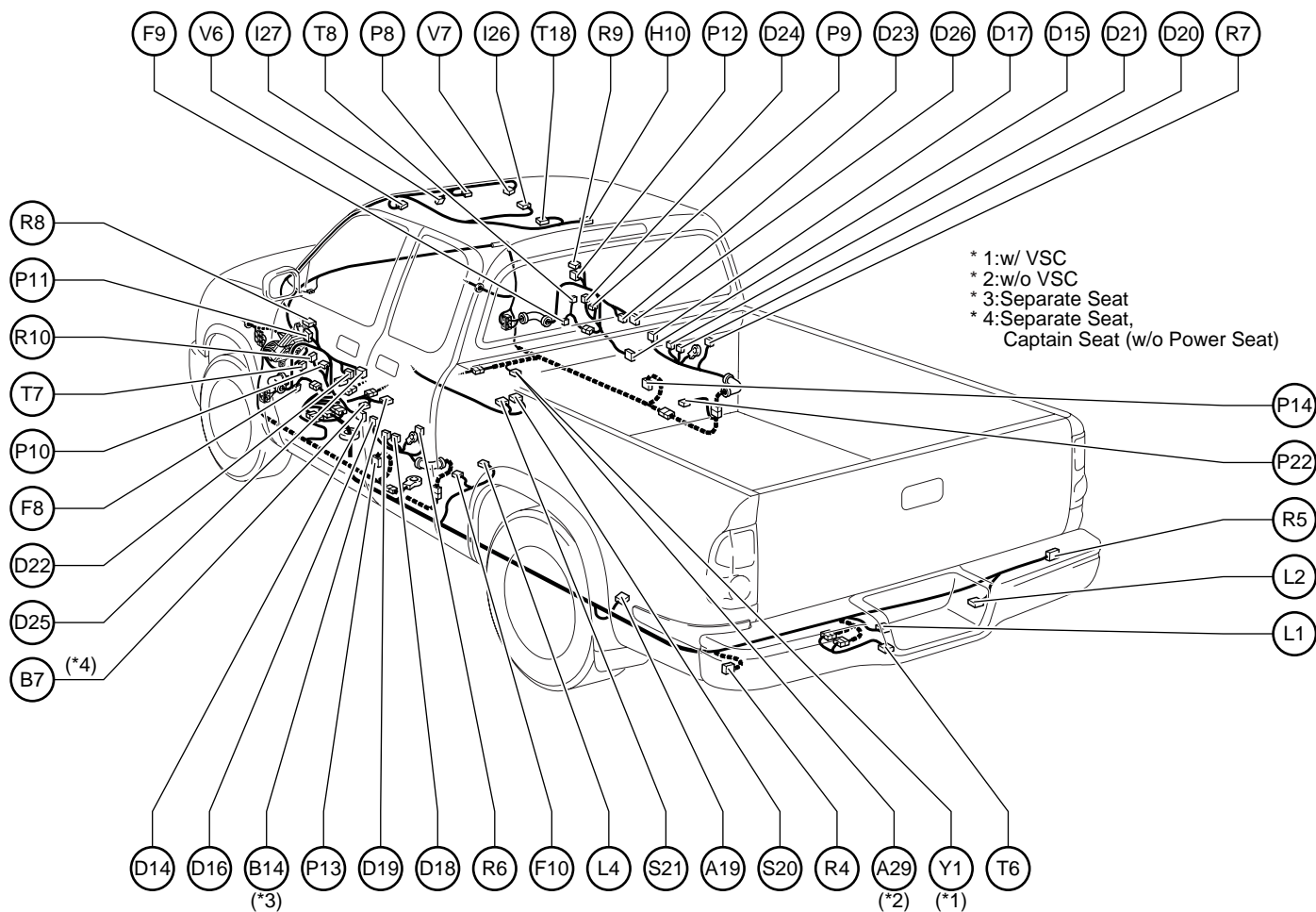

A 19 ABS Speed Sensor Rear  
A 29 ABS Deceleration Sensor

B 7 Buckle SW LH  
B 14 Buckle SW LH  
Seat Position Airbag Sensor

D 14 Door Courtesy Light Front LH  
D 15 Door Courtesy Light Front RH  
D 16 Door Courtesy SW Front LH  
D 17 Door Courtesy SW Front RH  
D 18 Door Courtesy SW Rear LH Lower  
D 19 Door Courtesy SW Rear LH Upper  
D 20 Door Courtesy SW Rear RH Lower  
D 21 Door Courtesy SW Rear RH Upper  
D 22 Door Key Lock and Unlock SW LH  
D 23 Door Key Lock and Unlock SW RH  
D 24 Door Lock Control SW RH  
D 25 Door Lock Motor and Door Unlock Detection SW LH  
D 26 Door Lock Motor and Door Unlock Detection SW RH

F 8 Front Door Speaker LH  
F 9 Front Door Speaker RH  
F 10 Fuel Pump and Sender

H 10 Cargo Light  
High Mounted Stop Light

I 26 Interior Light  
I 27 Inner Mirror

L 1 License Plate Light LH  
L 2 License Plate Light RH  
L 4 Canister Pump Module

P 8 Personal Light  
P 9 Power Window Control SW Front RH  
P 10 Power Window Master SW  
P 11 Power Window Motor Front LH  
P 12 Power Window Motor Front RH  
P 13 Pretensioner LH  
P 14 Pretensioner RH  
P 22 Power Window Motor (Back Window)

R 4 Rear Combination Light LH  
R 5 Rear Combination Light RH  
R 6 Rear Door Speaker LH  
R 7 Rear Door Speaker RH  
R 8 Remote Control Mirror LH  
R 9 Remote Control Mirror RH  
R 10 Remote Control Mirror SW

S 20 Stereo Component Amplifier  
S 21 Stereo Component Amplifier

T 6 Trailer Socket  
T 7 Tweeter LH  
T 8 Tweeter RH  
T 18 Tire Pressure Monitor Receiver

V 6 Vanity Light LH  
V 7 Vanity Light RH

Y 1 Yaw Rate Sensor

## Position of Parts in Body

### [Standard Cab]

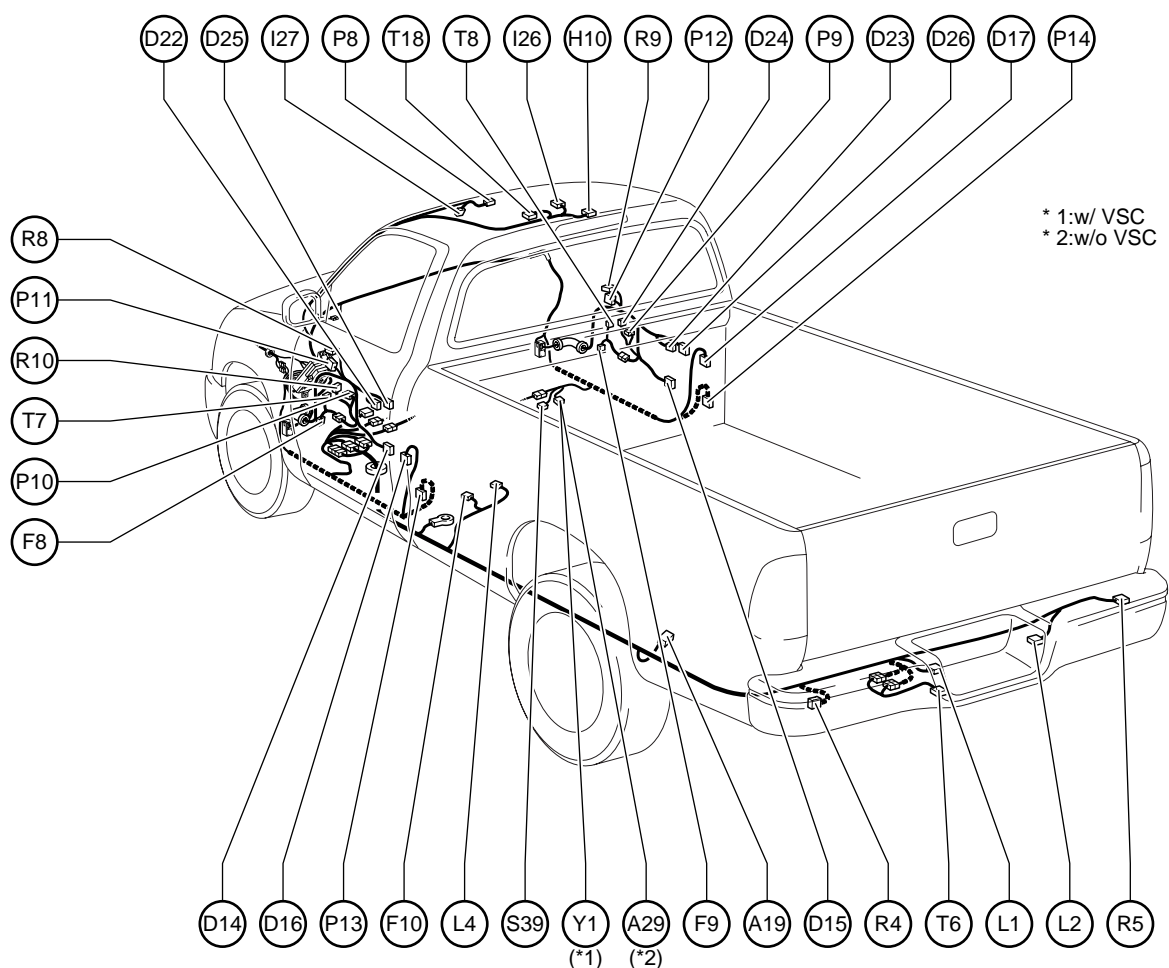

A 19 ABS Speed Sensor Rear  
A 29 ABS Deceleration Sensor

D 14 Door Courtesy Light Front LH  
D 15 Door Courtesy Light Front RH  
D 16 Door Courtesy SW Front LH  
D 17 Door Courtesy SW Front RH  
D 22 Door Key Lock and Unlock SW LH  
D 23 Door Key Lock and Unlock SW RH  
D 24 Door Lock Control SW RH  
D 25 Door Lock Motor  
Door Unlock Detection SW LH  
D 26 Door Lock Motor  
Door Unlock Detection SW RH

F 8 Front Door Speaker LH  
F 9 Front Door Speaker RH  
F 10 Fuel Pump  
Sender

H 10 Cargo Light  
High Mounted Stop Light

I 26 Interior Light  
I 27 Inner Mirror

L 1 License Plate Light LH  
L 2 License Plate Light RH  
L 4 Canister Pump Module

P 8 Personal Light  
P 9 Power Window Control SW Front RH  
P 10 Power Window Master SW  
P 11 Power Window Motor Front LH  
P 12 Power Window Motor Front RH  
P 13 Pretensioner LH  
P 14 Pretensioner RH

R 4 Rear Combination Light LH  
R 5 Rear Combination Light RH  
R 8 Remote Control Mirror LH  
R 9 Remote Control Mirror RH  
R 10 Remote Control Mirror SW

S 39 Seat Belt Tension Sensor

T 6 Trailer Socket  
T 7 Tweeter LH  
T 8 Tweeter RH  
T 18 Tire Pressure Monitor Receiver

Y 1 Yaw Rate Sensor

## G ELECTRICAL WIRING ROUTING

### Position of Parts in Seat

[Access Cab : Captain Seat]

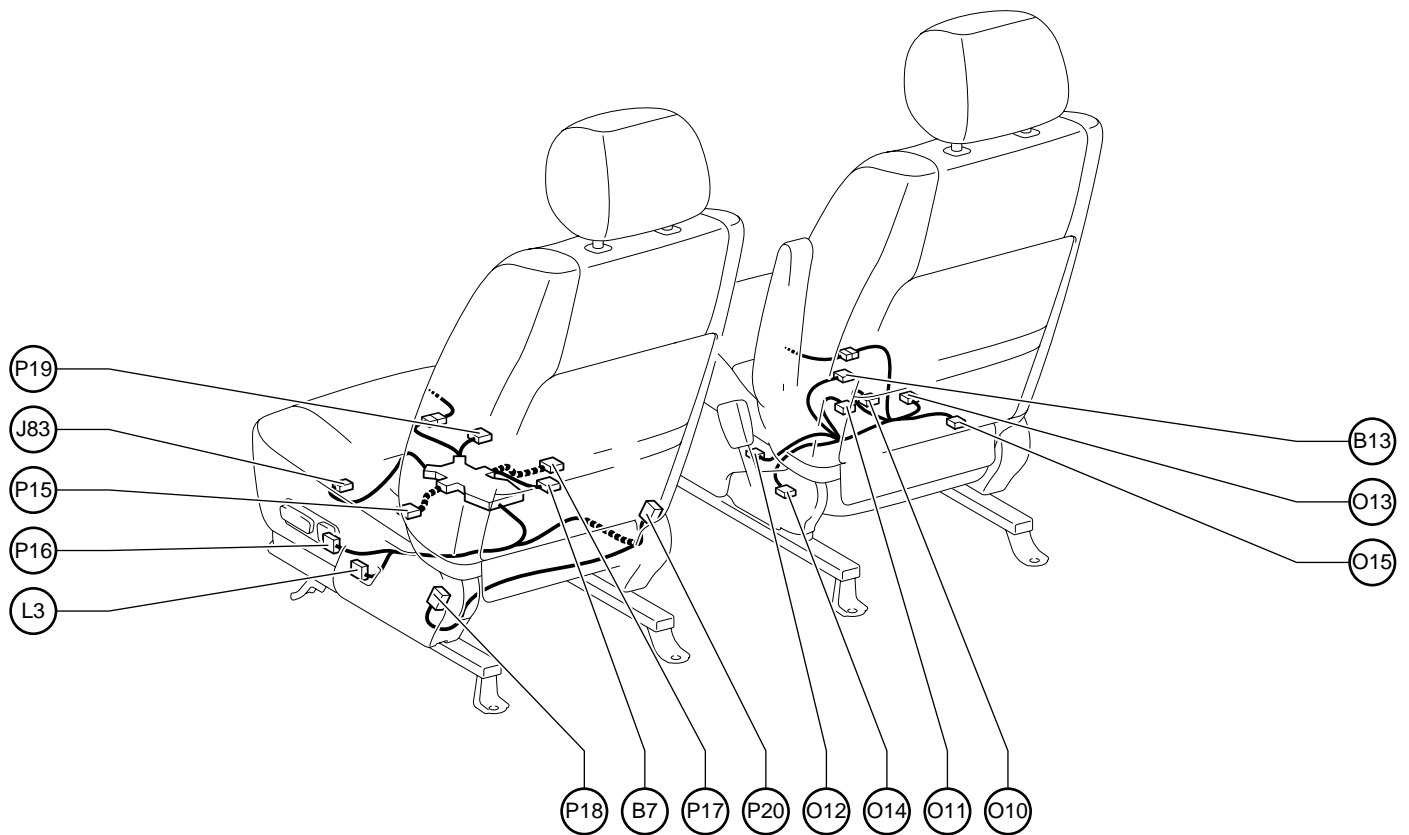

B 7 Buckle SW LH

B13 Buckle SW RH

J 83 Junction Connector

L 3 Lumbar Support Control SW (Driver's Seat)

O10 Occupant Classification ECU

O11 Occupant Classification ECU

O12 Occupant Classification Sensor Front LH

O13 Occupant Classification Sensor Front RH

O14 Occupant Classification Sensor RearLH

O15 Occupant Classification Sensor RearRH

P15 Power Seat Motor (Driver's Seat Front Vertical Control)

P16 Power Seat Control SW (Driver's Seat)

P17 Power Seat Motor (Driver's Seat Rear Vertical Control)

P18 Power Seat Motor (Driver's Seat Reclining Control)

P19 Power Seat Motor (Driver's Seat Slide Control)

P20 Power Seat Motor  
(Driver's Seat Lumbar Support Control)

## Position of Parts in Seat

[Access Cab : Separate Seat]

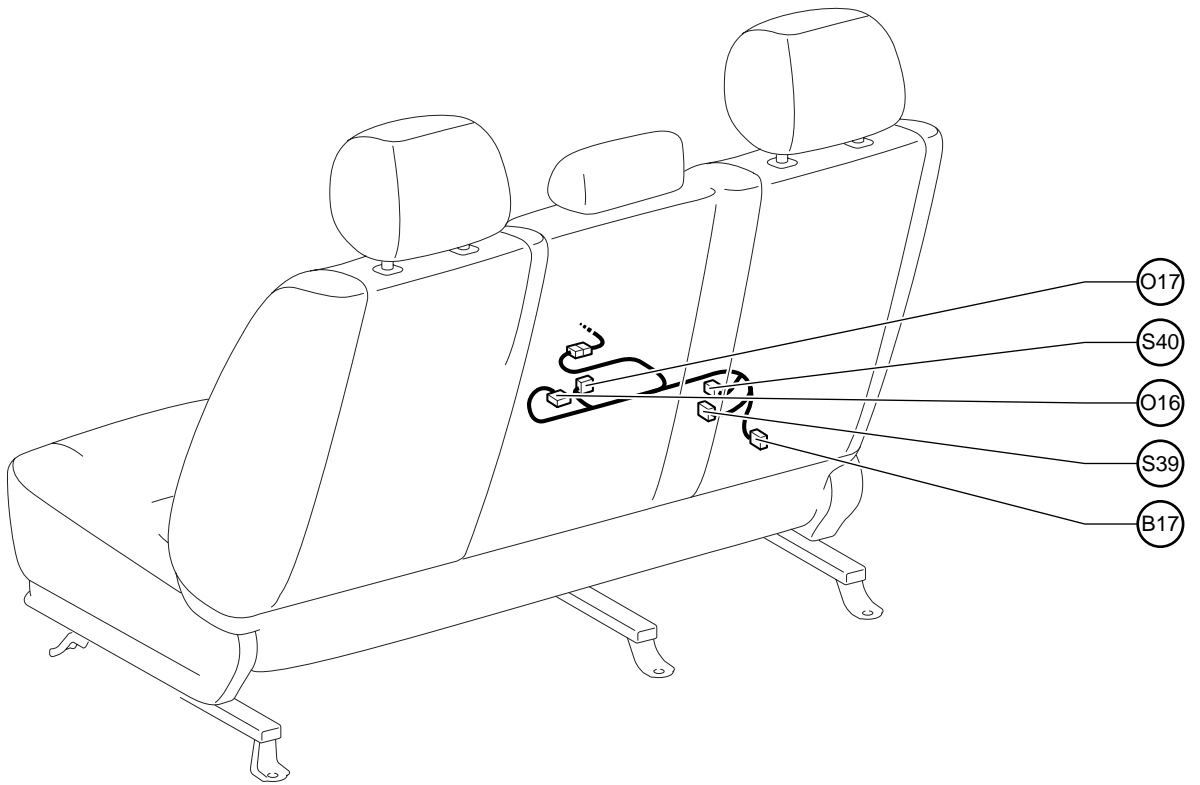

B17 Buckle SW RH

O16 Occupant Classification ECU

O17 Occupant Classification Sensor

S39 Seat Belt Tension Sensor

S40 Seat Position Airbag Sensor (Front Passenger's Side)

## G ELECTRICAL WIRING ROUTING

### Position of Parts in Seat

[Standard Cab : Bench Seat]

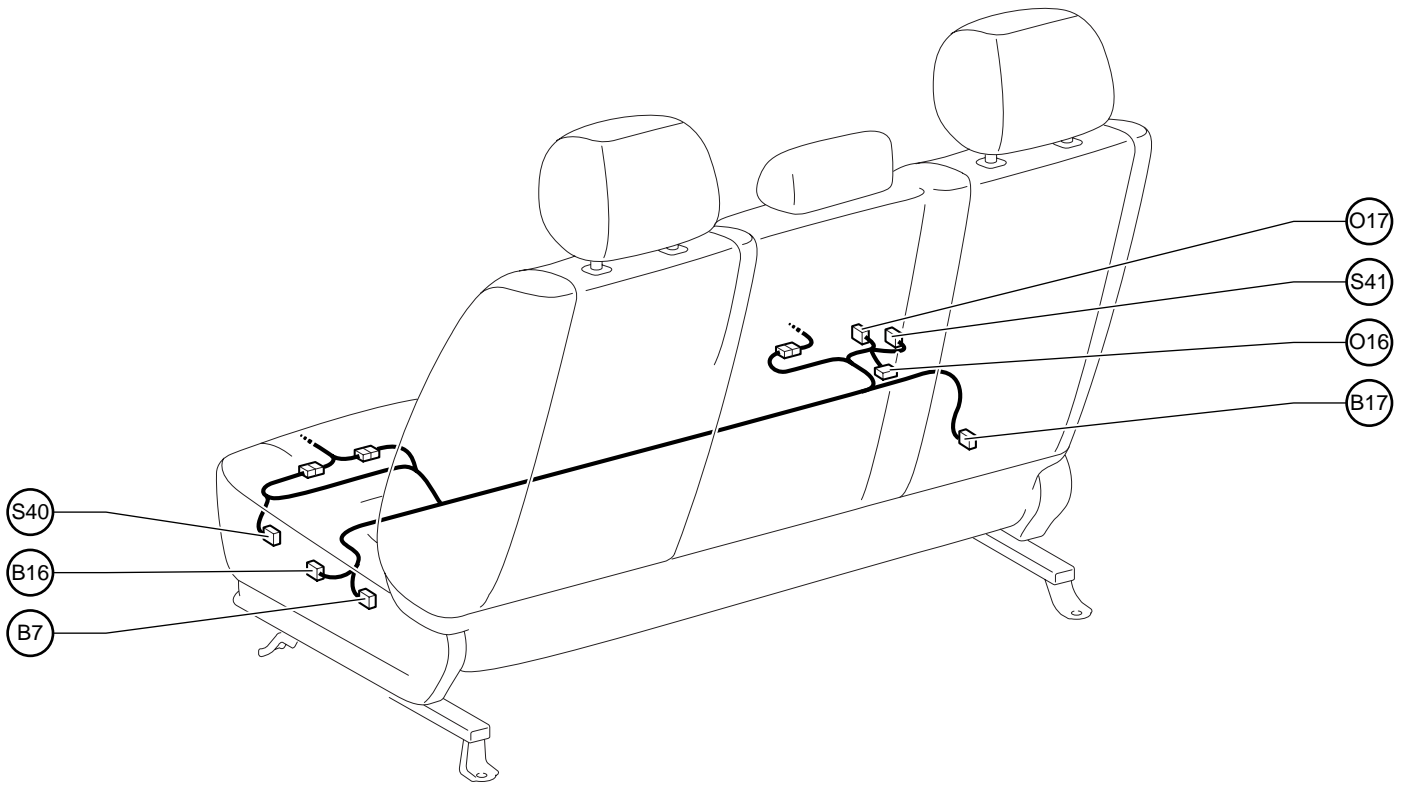

B 7 Buckle SW LH  
B16 Buckle SW LH  
B17 Buckle SW RH

S40 Seat Position Airbag Sensor (Front Passenger's Side)  
S41 Seat Position Airbag Sensor (Driver's Side)

O16 Occupant Classification ECU  
O17 Occupant Classification Sensor





# G ELECTRICAL WIRING ROUTING

## Position of Parts in Engine Compartment

[Double Cab]

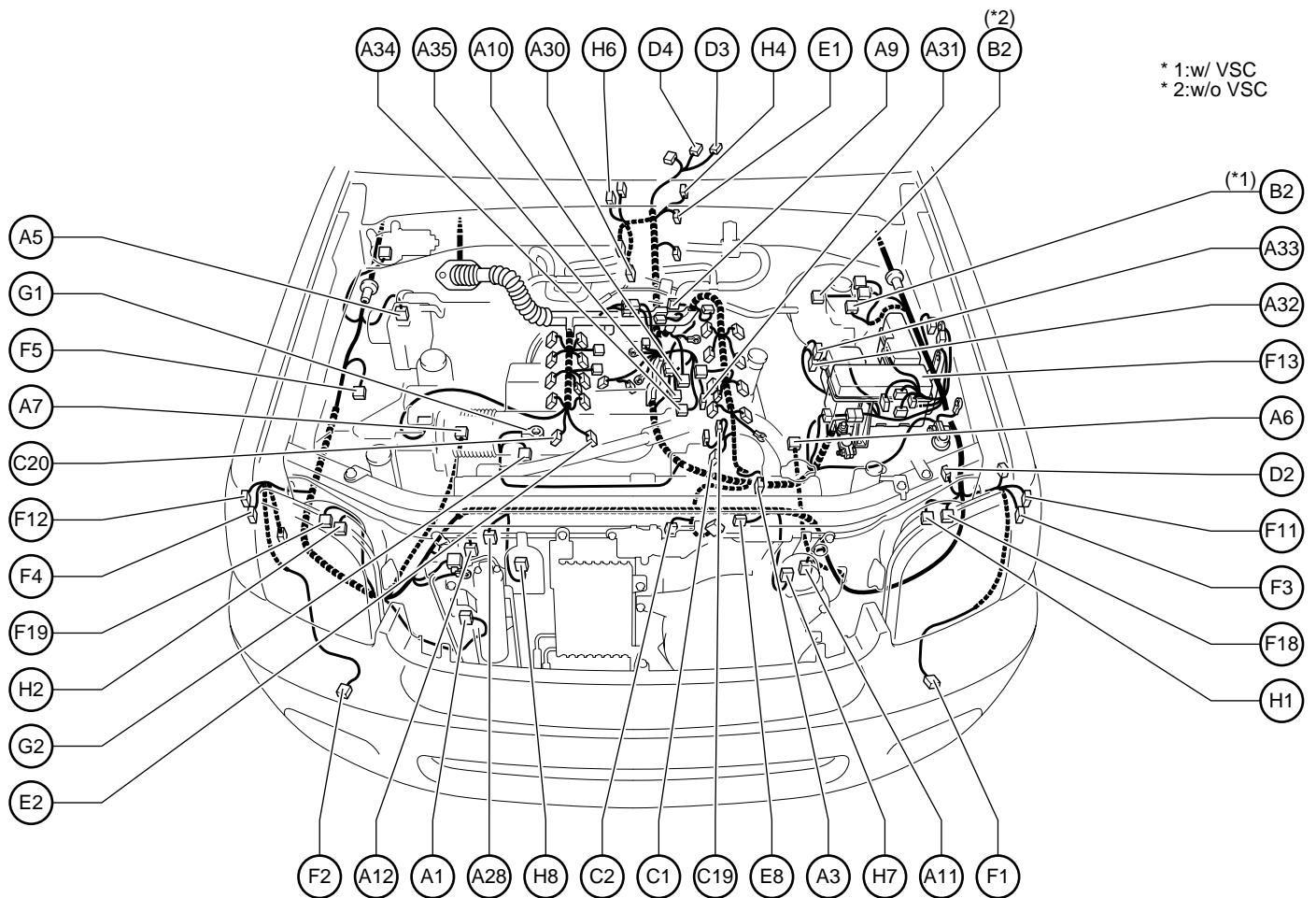

\* 1:w/ VSC  
\* 2:w/o VSC

- A 1 Pressure SW
- A 3 A/C Magnetic Clutch and Lock Sensor
- A 5 ABS Actuator with ECU
- A 6 ABS Speed Sensor Front LH
- A 7 ABS Speed Sensor Front RH
- A 9 ADD Actuator
- A10 Air Fuel Ratio Sensor (Bank 1 Sensor 1)
- A11 Airbag Sensor Front LH
- A12 Airbag Sensor Front RH
- A28 Ambient Temp. Sensor
- A30 Air Fuel Ratio Sensor (Bank 2 Sensor 1)
- A31 Air Switching Valve
- A32 Air Injection Control Driver
- A33 Air Injection Control Driver
- A34 Air Pressure Sensor
- A35 Air Pump

- B 2 Brake Fluid Level Warning SW

- C 1 Camshaft Position Sensor
- C 2 Crankshaft Position Sensor
- C19 Camshaft Timing Oil Control Valve LH
- C20 Camshaft Timing Oil Control Valve RH

- D 2 Daytime Running Light Resistor
- D 3 Detection SW (Transfer 4WD Position)
- D 4 Detection SW (Transfer L4 Position)

- E 1 Electronically Controlled Transmission Solenoid
- E 2 Engine Coolant Temp. Sensor
- E 8 Engine Hood Courtesy SW

- F 1 Front Fog Light LH
- F 2 Front Fog Light RH
- F 3 Front Turn Signal Light and Parking Light LH
- F 4 Front Turn Signal Light and Parking Light RH
- F 5 Fuel Pump Resistor
- F 11 Front Turn Signal Light and Parking Light LH No.2
- F 12 Front Turn Signal Light and Parking Light RH No.2
- F 13 Fusible Link Block
- F 18 Front Parking Light LH No.3
- F 19 Front Parking Light RH No.3

- G 1 Generator
- G 2 Generator

- H 1 Headlight LH
- H 2 Headlight RH
- H 4 Heated Oxygen Sensor (Bank 1 Sensor 2)
- H 6 Heated Oxygen Sensor (Bank 2 Sensor 2)
- H 7 Horn LH
- H 8 Horn RH

## Position of Parts in Engine Compartment

### [Double Cab]

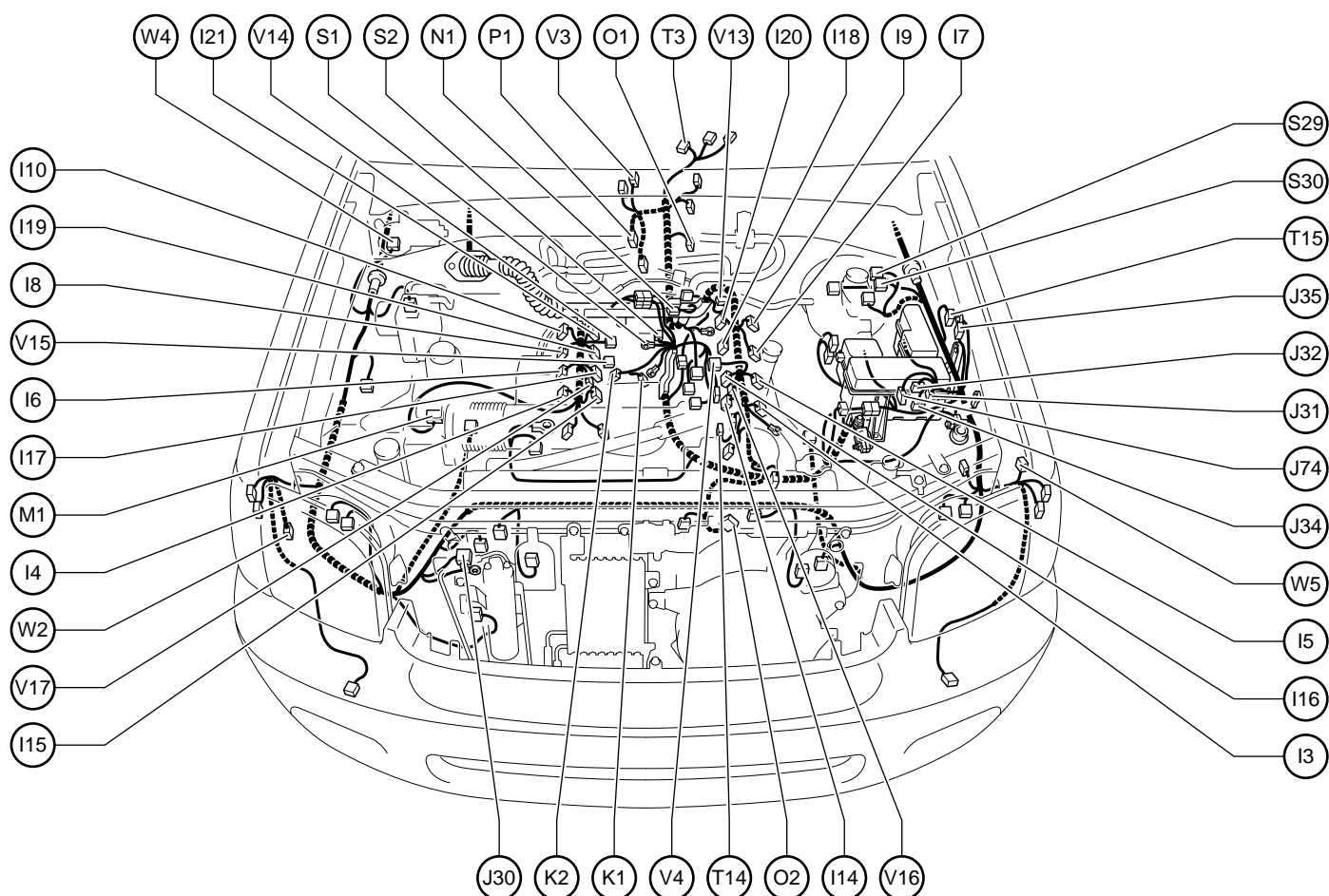

- I 3 Igniter and Ignition Coil No.1
- I 4 Igniter and Ignition Coil No.2
- I 5 Igniter and Ignition Coil No.3
- I 6 Igniter and Ignition Coil No.4
- I 7 Igniter and Ignition Coil No.5
- I 8 Igniter and Ignition Coil No.6
- I 9 Igniter and Ignition Coil No.7
- I 10 Igniter and Ignition Coil No.8
- I 14 Injector No.1
- I 15 Injector No.2
- I 16 Injector No.3
- I 17 Injector No.4
- I 18 Injector No.5
- I 19 Injector No.6
- I 20 Injector No.7
- I 21 Injector No.8

- J 30 Junction Connector
- J 31 Junction Connector
- J 32 Junction Connector
- J 34 Junction Connector
- J 35 Junction Connector
- J 74 Junction Connector

- K 1 Knock Sensor (Bank 1)
- K 2 Knock Sensor (Bank 2)

- M 1 Mass Air Flow Meter

- N 1 Noise Filter

- O 1 O/D Direct Clutch Speed Sensor
- O 2 Oil Pressure SW

- P 1 Park/Neutral Position SW

- S 1 Starter
- S 2 Starter
- S29 Skid Control ECU with Actuator
- S30 Skid Control ECU with Actuator

- T 3 Transfer Shift Actuator
- T 14 Throttle Control Motor and Throttle Position Sensor
- T 15 Theft Deterrent Horn

- V 3 Vehicle Speed Sensor  
(Electronically Controlled Transmission)
- V 4 VSV (Purge)
- V 13 VSV (ACIS)
- V 14 VSV (Air Switching Valve Bank 1)
- V 15 VSV (Air Switching Valve Bank 2)
- V 16 VVT Sensor LH
- V 17 VVT Sensor RH

- W 2 Washer Motor and Washer Level Sensor
- W 4 Wiper Motor
- W 5 Wireless Door Lock Buzzer

## G ELECTRICAL WIRING ROUTING

### Position of Parts in Instrument Panel

[Double Cab]

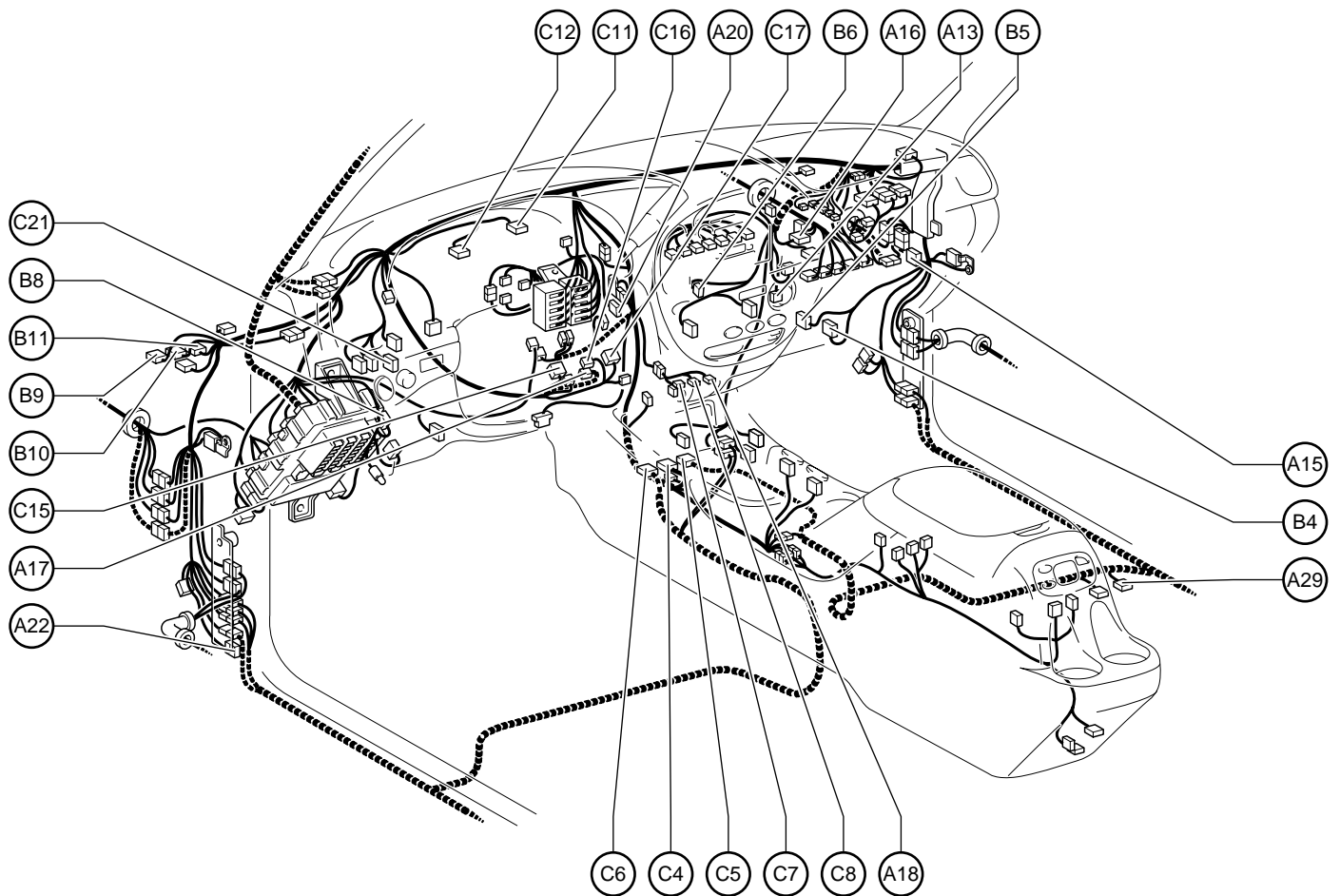

A13 A/C Thermistor  
 A15 Air Inlet Control Servo Motor  
 A16 Airbag Squib (Front Passenger Airbag Assembly)  
 A17 Airbag Squib (Steering Wheel Pad)  
 A18 Ashtray Illumination  
 A20 Accelerator Pedal Position Sensor  
 A22 ACC Cut Relay  
 A29 ABS Deceleration Sensor

B 4 Blower Motor  
 B 5 Blower Resistor  
 B 6 Blower SW and Defroster Mode SW  
 B 8 Back Window Relay  
 B 9 Body ECU  
 B10 Body ECU  
 B11 Body ECU

C 4 Center Airbag Sensor Assembly  
 C 5 Center Airbag Sensor Assembly  
 C 6 Center Airbag Sensor Assembly  
 C 7 Cigarette Lighter  
 C 8 Cigarette Lighter Illumination  
 C11 Combination Meter  
 C12 Combination Meter  
 C15 Combination SW  
 C16 Combination SW  
 C17 Combination SW  
 C21 Curtain Airbag Cut Off SW

## Position of Parts in Instrument Panel

### [Double Cab]

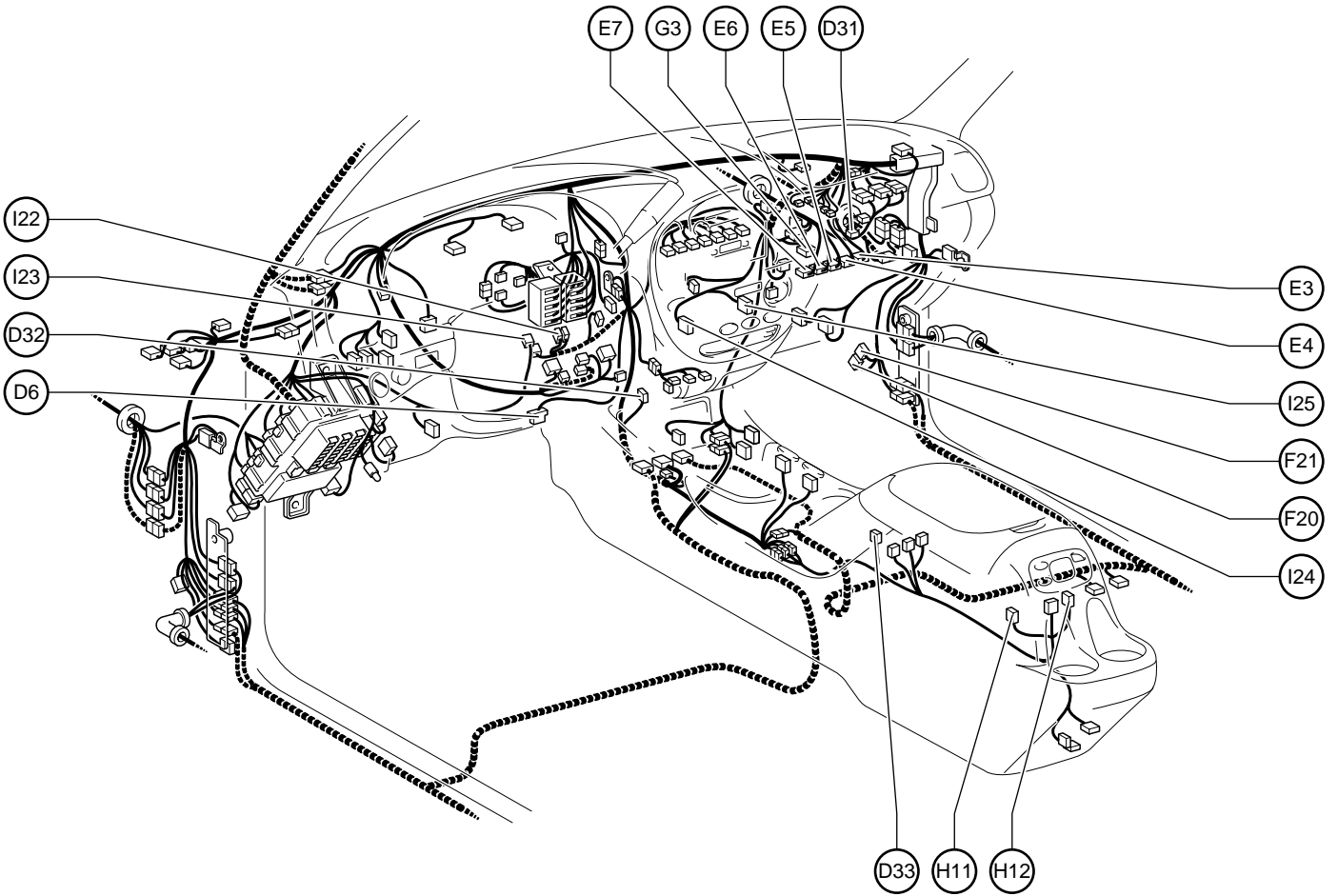

D 6 Data Link Connector 3  
 D31 Diode (Parking Brake SW)  
 D32 Door Lock Control Receiver  
 D33 DVD Player

E 3 Engine Control Module  
 E 4 Engine Control Module  
 E 5 Engine Control Module  
 E 6 Engine Control Module  
 E 7 Engine Control Module

F20 4WD Control ECU  
 F21 4WD Control ECU

G 3 Glove Box Light

H11 Headphone Terminal LH  
 H12 Headphone Terminal RH

I 22 Ignition Key Cylinder Light  
 I 23 Ignition SW  
 I 24 Integration Control and Panel  
 I 25 Integration Control and Panel

## G ELECTRICAL WIRING ROUTING

### Position of Parts in Instrument Panel

[Double Cab]

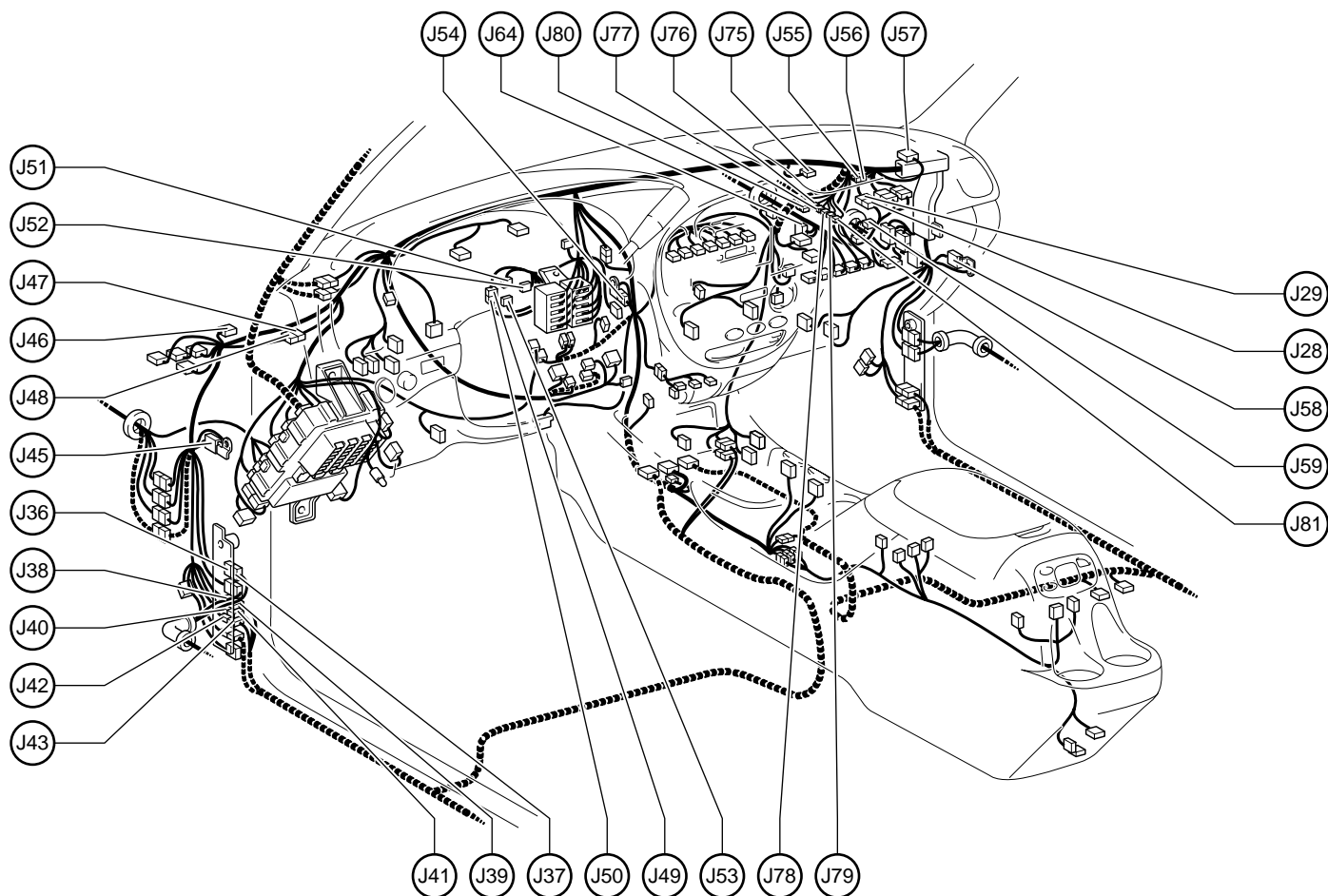

J 28 Junction Connector  
 J 29 Junction Connector  
 J 36 Junction Connector  
 J 37 Junction Connector  
 J 38 Junction Connector  
 J 39 Junction Connector  
 J 40 Junction Connector  
 J 41 Junction Connector  
 J 42 Junction Connector  
 J 43 Junction Connector  
 J 45 Junction Connector  
 J 46 Junction Connector  
 J 47 Junction Connector  
 J 48 Junction Connector  
 J 49 Junction Connector  
 J 50 Junction Connector  
 J 51 Junction Connector

J 52 Junction Connector  
 J 53 Junction Connector  
 J 54 Junction Connector  
 J 55 Junction Connector  
 J 56 Junction Connector  
 J 57 Junction Connector  
 J 58 Junction Connector  
 J 59 Junction Connector  
 J 64 Junction Connector  
 J 75 Junction Connector  
 J 76 Junction Connector  
 J 77 Junction Connector  
 J 78 Junction Connector  
 J 79 Junction Connector  
 J 80 Junction Connector  
 J 81 Junction Connector



## Position of Parts in Instrument Panel

### [Double Cab]

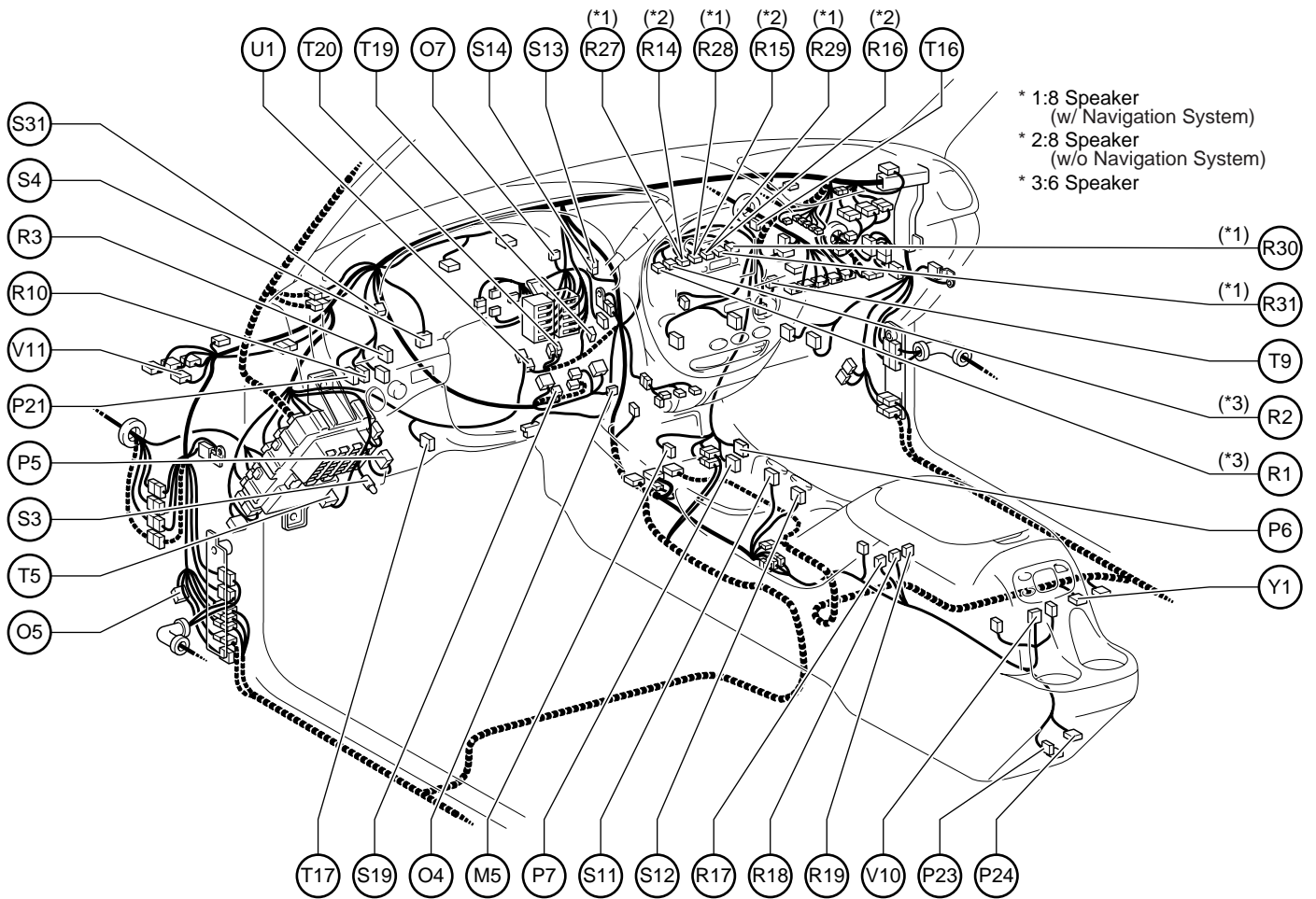

M 5 Main SW

O 4 O/D Main SW  
O 5 Option Connector  
O 7 Option Connector (Grass Breakage Sensor)

P 5 Parking Brake SW  
P 6 Power Outlet  
P 7 Power Outlet  
P 21 Power Window Control SW (Back Window)  
P 23 Power Outlet (115V)  
P 24 Power Outlet (Rear)

R 1 Radio and Player  
R 2 Radio and Player  
R 3 Rheostat  
R 10 Remote Control Mirror SW  
R 14 Radio and Player  
R 15 Radio and Player  
R 16 Radio and Player  
R 17 Rear Seat Entertainment ECU  
R 18 Rear Seat Entertainment ECU  
R 19 Rear Seat Entertainment ECU  
R 27 Radio and Player with Display  
R 28 Radio and Player with Display  
R 29 Radio and Player with Display  
R 30 Radio and Player with Display  
R 31 Radio and Player with Display

S 3 Step Light  
S 4 Stop Light SW  
S 11 Seat Heater SW (Driver's Seat)  
S 12 Seat Heater SW (Front Passenger's Seat)  
S 13 Short Connector  
S 14 Short Connector  
S 19 Steering Sensor  
S 31 Stop Light Relay

T 5 Turn Signal Flasher  
T 9 Trailer Converter  
T 16 Tire Pressure Monitor ECU  
T 17 Tire Pressure Warning Standardization SW  
T 19 Transponder Key Computer  
T 20 Transponder Key Amplifier

U 1 Unlock Warning SW

V 10 Video Terminal  
V 11 VSC Warning Buzzer

Y 1 Yaw Rate Sensor



## G ELECTRICAL WIRING ROUTING

### Position of Parts in Body

#### [Double Cab]

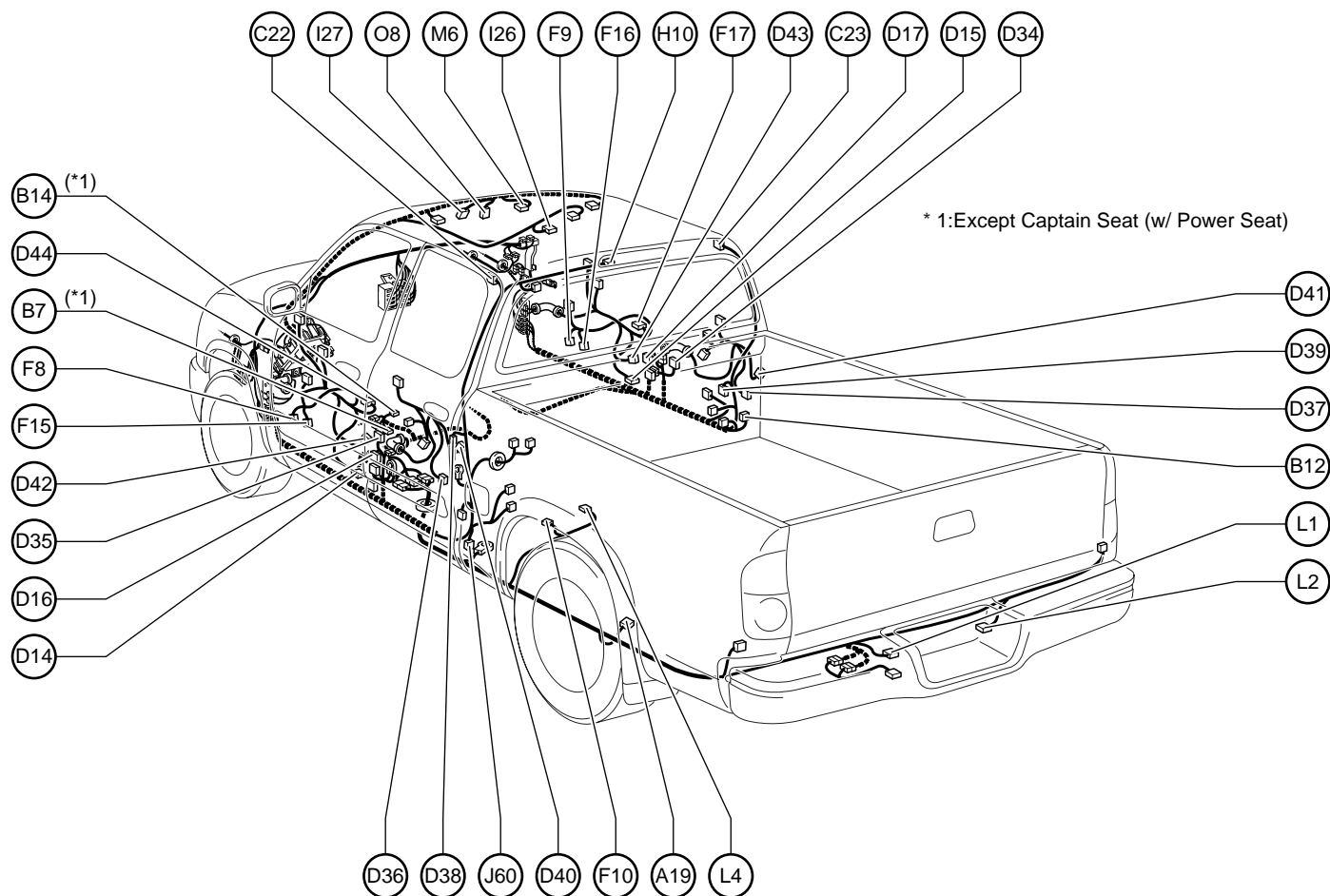

A 19 ABS Speed Sensor Rear

B 7 Buckle SW LH  
B 12 Back Window Control Relay  
B 14 Buckle SW LH  
Seat Position Airbag Sensor

C 22 Curtain Shield Airbag Squib LH  
C 23 Curtain Shield Airbag Squib RH

D 14 Door Courtesy Light Front LH  
D 15 Door Courtesy Light Front RH  
D 16 Door Courtesy SW Front LH  
D 17 Door Courtesy SW Front RH  
D 34 Diode (Door Courtesy No.1)  
D 35 Diode (Door Courtesy No.2)  
D 36 Door Courtesy Light Rear LH  
D 37 Door Courtesy Light Rear RH  
D 38 Door Courtesy SW Rear LH  
D 39 Door Courtesy SW Rear RH  
D 40 Door Lock Motor  
Door Unlock Detection SW Rear LH  
D 41 Door Lock Motor  
Door Unlock Detection SW Rear RH  
D 42 Door Lock Motor, Door Key Lock and Unlock SW  
Door Unlock Detection SW Front LH  
D 43 Door Lock Motor, Door Key Lock and Unlock SW  
Door Unlock Detection SW Front RH  
D 44 Driver Door ECU

F 8 Front Door Speaker LH  
F 9 Front Door Speaker RH  
F 10 Fuel Pump and Sender  
F 15 Front Door Speaker LH (Woofer)  
F 16 Front Door Speaker RH (Woofer)  
F 17 Front Passenger Door ECU

H 10 High Mounted Stop Light and Cargo Light

I 26 Interior Light  
I 27 Inner Mirror

J 60 Junction Connector

L 1 License Plate Light LH  
L 2 License Plate Light RH  
L 4 Canister Pump Module

M 6 Moon Roof Control ECU and Motor

O 8 Overhead Module

## Position of Parts in Body

### [Double Cab]

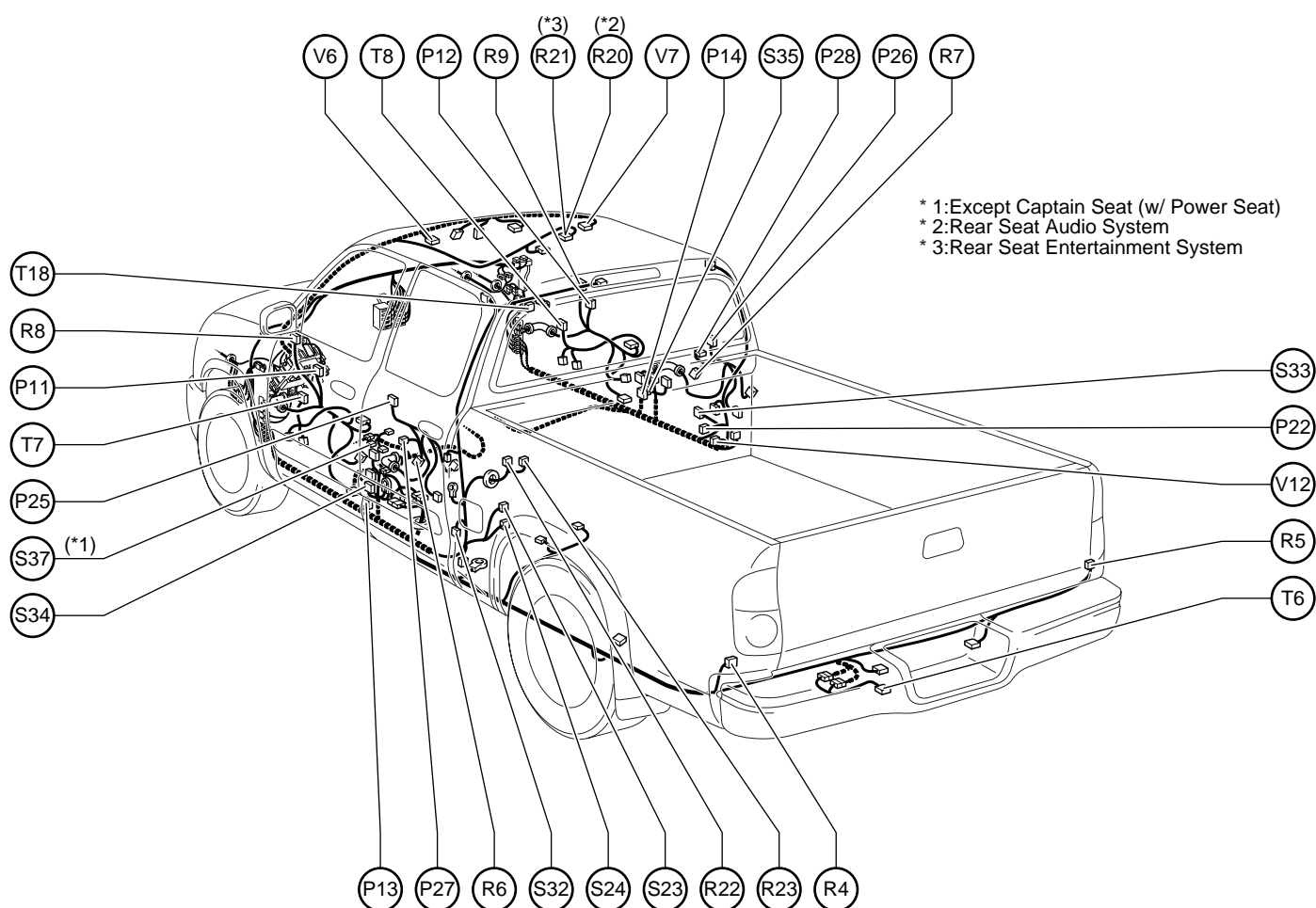

\* 1:Except Captain Seat (w/ Power Seat)  
 \* 2:Rear Seat Audio System  
 \* 3:Rear Seat Entertainment System

P 11 Power Window Motor Front LH  
 P 12 Power Window Motor Front RH  
 P 13 Pretensioner LH  
 P 14 Pretensioner RH  
 P 22 Power Window Motor (Back Window)  
 P 25 Power Window Control SW Rear LH  
 P 26 Power Window Control SW Rear RH  
 P 27 Power Window Motor Rear LH  
 P 28 Power Window Motor Rear RH

R 4 Rear Combination Light LH  
 R 5 Rear Combination Light RH  
 R 6 Rear Door Speaker LH  
 R 7 Rear Door Speaker RH  
 R 8 Remote Control Mirror LH  
 R 9 Remote Control Mirror RH  
 R 20 Rear Seat Audio Controller  
 R 21 Rear Seat Entertainment Display  
 R 22 Rear Window Defogger  
 R 23 Rear Window Defogger

S 23 Stereo Component Amplifier  
 S 24 Stereo Component Amplifier  
 S 32 Side Airbag Sensor Rear LH  
 S 33 Side Airbag Sensor Rear RH  
 S 34 Side Airbag Sensor LH  
 S 35 Side Airbag Sensor RH  
 S 37 Side Airbag Squib LH

T 6 Trailer Socket  
 T 7 Tweeter LH  
 T 8 Tweeter RH  
 T 18 Tire Pressure Monitor Receiver

V 6 Vanity Light LH  
 V 7 Vanity Light RH  
 V 12 Voltage Inverter

## G ELECTRICAL WIRING ROUTING

### Position of Parts in Seat

#### [Double Cab : Captain Seat]

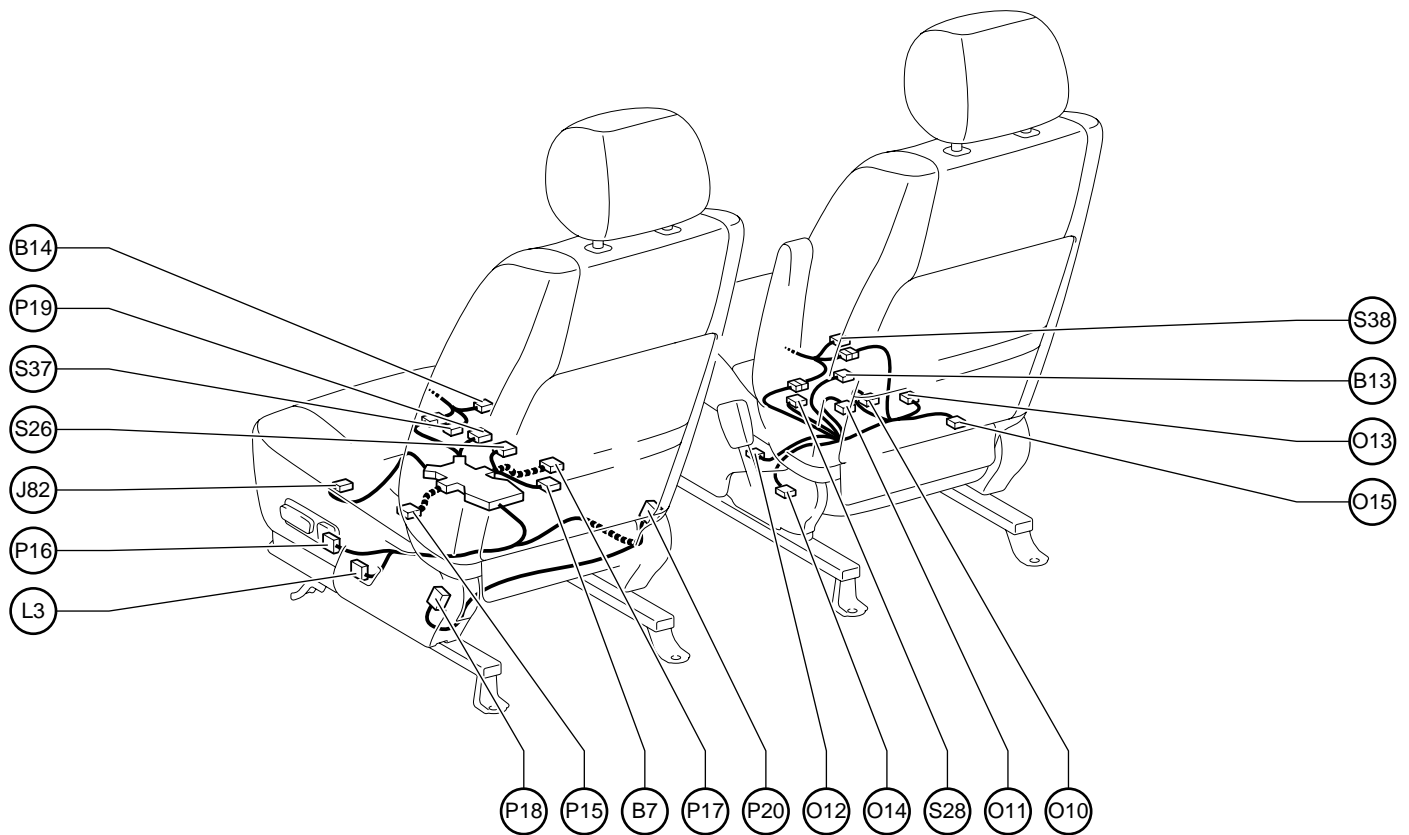

B 7 Buckle SW LH  
 B13 Buckle SW RH  
 B14 Buckle SW LH  
 Seat Position Airbag Sensor

J 82 Junction Connector

L 3 Lumbar Support Control SW (Driver's Seat)

O10 Occupant Classification ECU  
 O11 Occupant Classification ECU  
 O12 Occupant Classification Sensor Front LH  
 O13 Occupant Classification Sensor Front RH  
 O14 Occupant Classification Sensor RearLH  
 O15 Occupant Classification Sensor RearRH

P15 Power Seat Motor (Driver's Seat Front Vertical Control)  
 P16 Power Seat Control SW (Driver's Seat)  
 P17 Power Seat Motor (Driver's Seat Rear Vertical Control)  
 P18 Power Seat Motor (Driver's Seat Reclining Control)  
 P19 Power Seat Motor (Driver's Seat Slide Control)  
 P20 Power Seat Motor  
 (Driver's Seat Lumbar Support Control)

S26 Seat Heater (Driver's Seat)  
 S28 Seat Heater (Front Passenger's Seat)  
 S37 Side Airbag Squib LH  
 S38 Side Airbag Squib RH

## Position of Parts in Seat

### [Double Cab : Separate Seat]

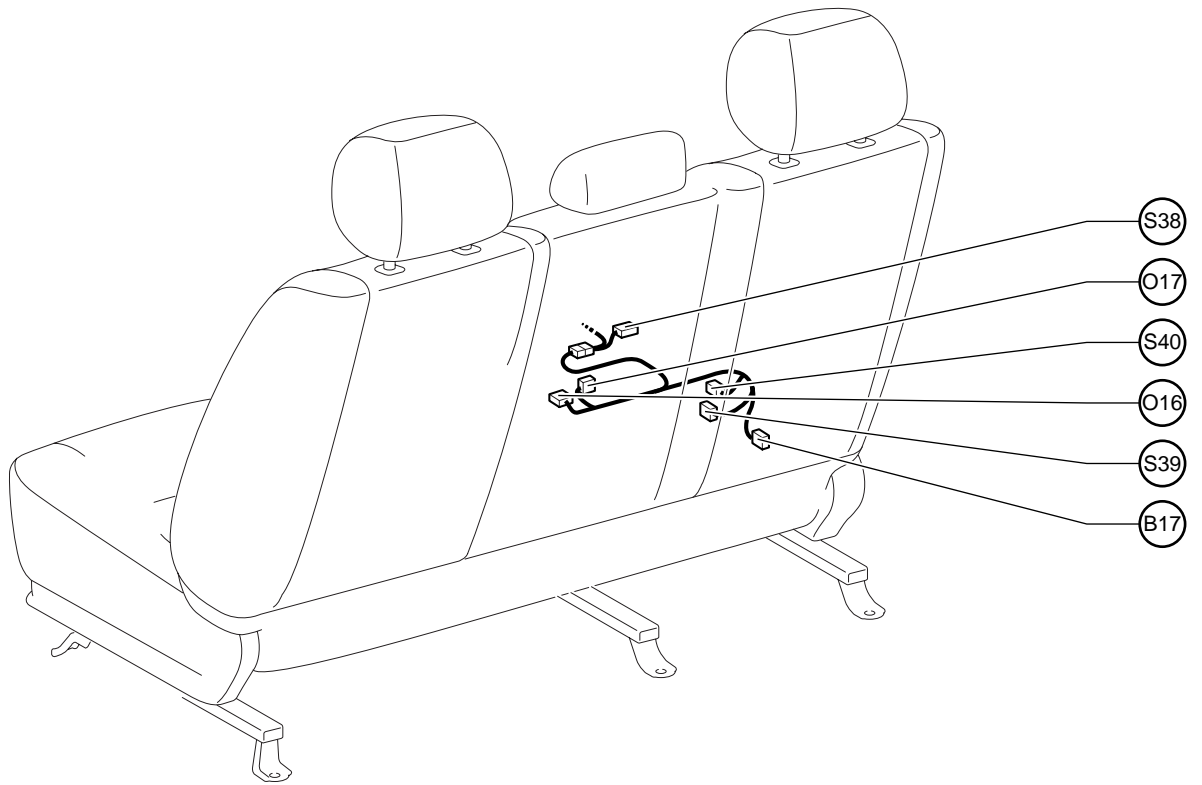

B17 Buckle SW RH

O16 Occupant Classification ECU

O17 Occupant Classification Sensor

S38 Side Airbag Squib RH

S39 Seat Belt Tension Sensor

S40 Seat Position Airbag Sensor (Front Passenger's Side)

## G ELECTRICAL WIRING ROUTING

□ : Location of Connector Joining Wire Harness and Wire Harness

▽ : Location of Ground Points

[Access Cab, Standard Cab : 2UZ-FE]

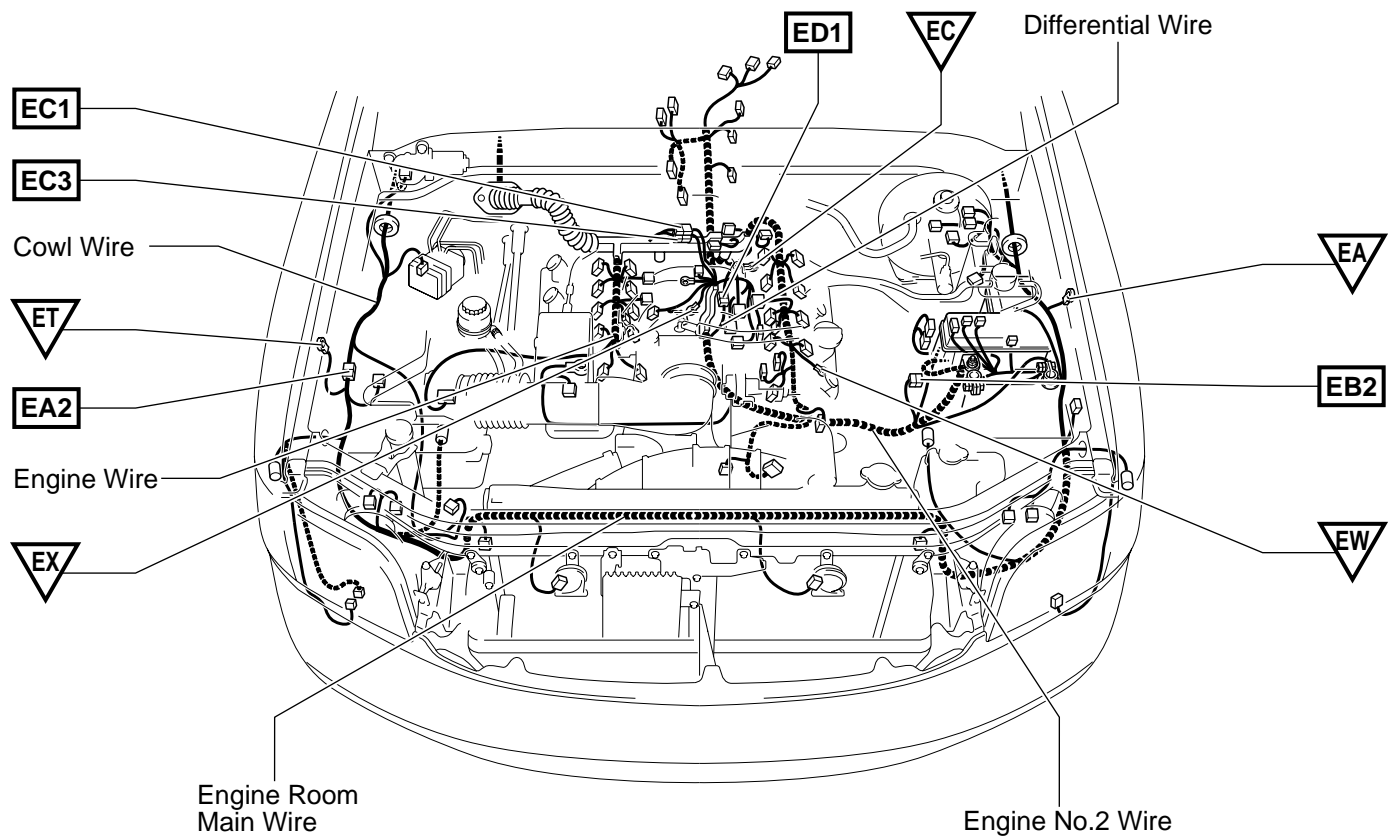

□ : Location of Connector Joining Wire Harness and Wire Harness

▽ : Location of Ground Points

[Access Cab, Standard Cab : 1GR-FE]

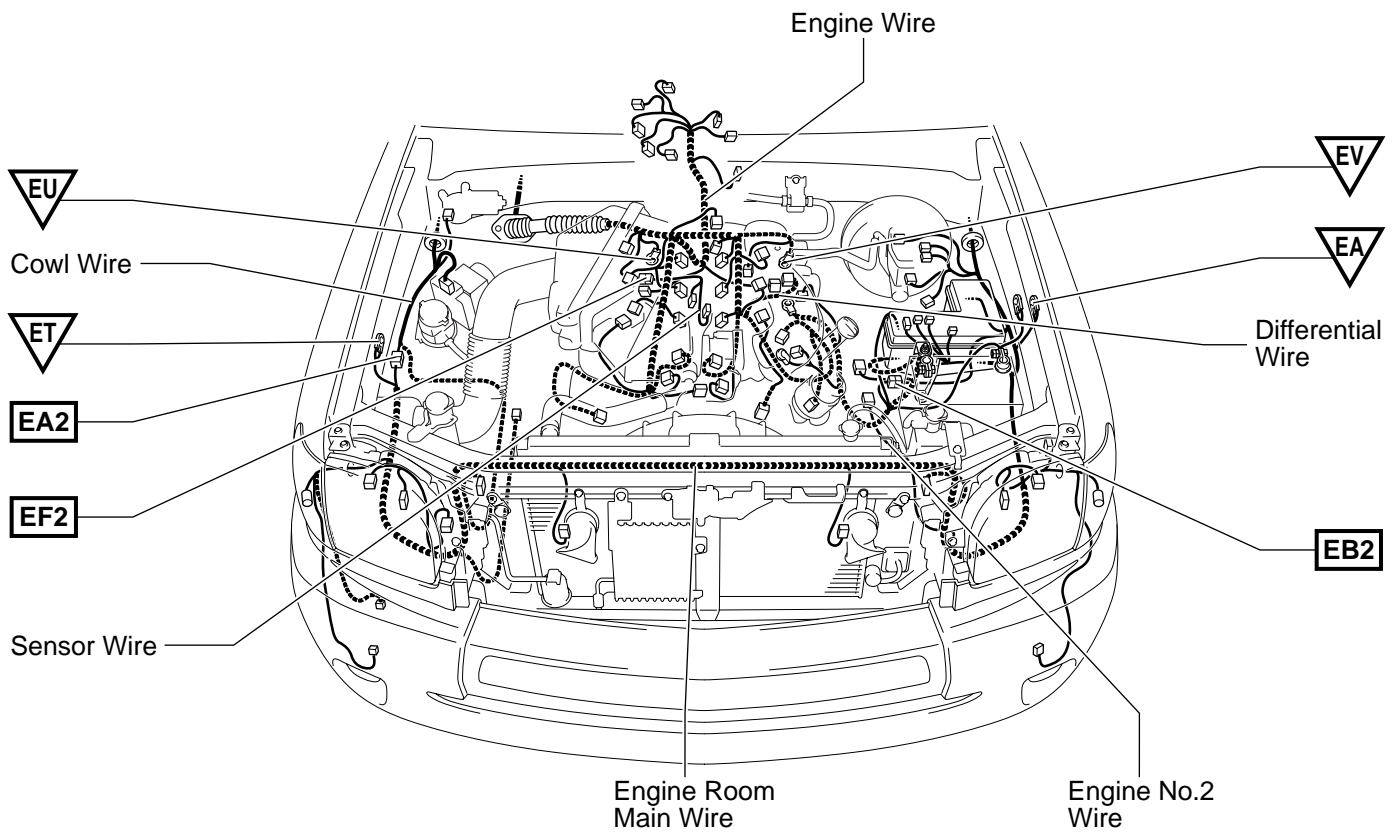



## G ELECTRICAL WIRING ROUTING

□ : Location of Connector Joining Wire Harness and Wire Harness

[Access Cab, Standard Cab]

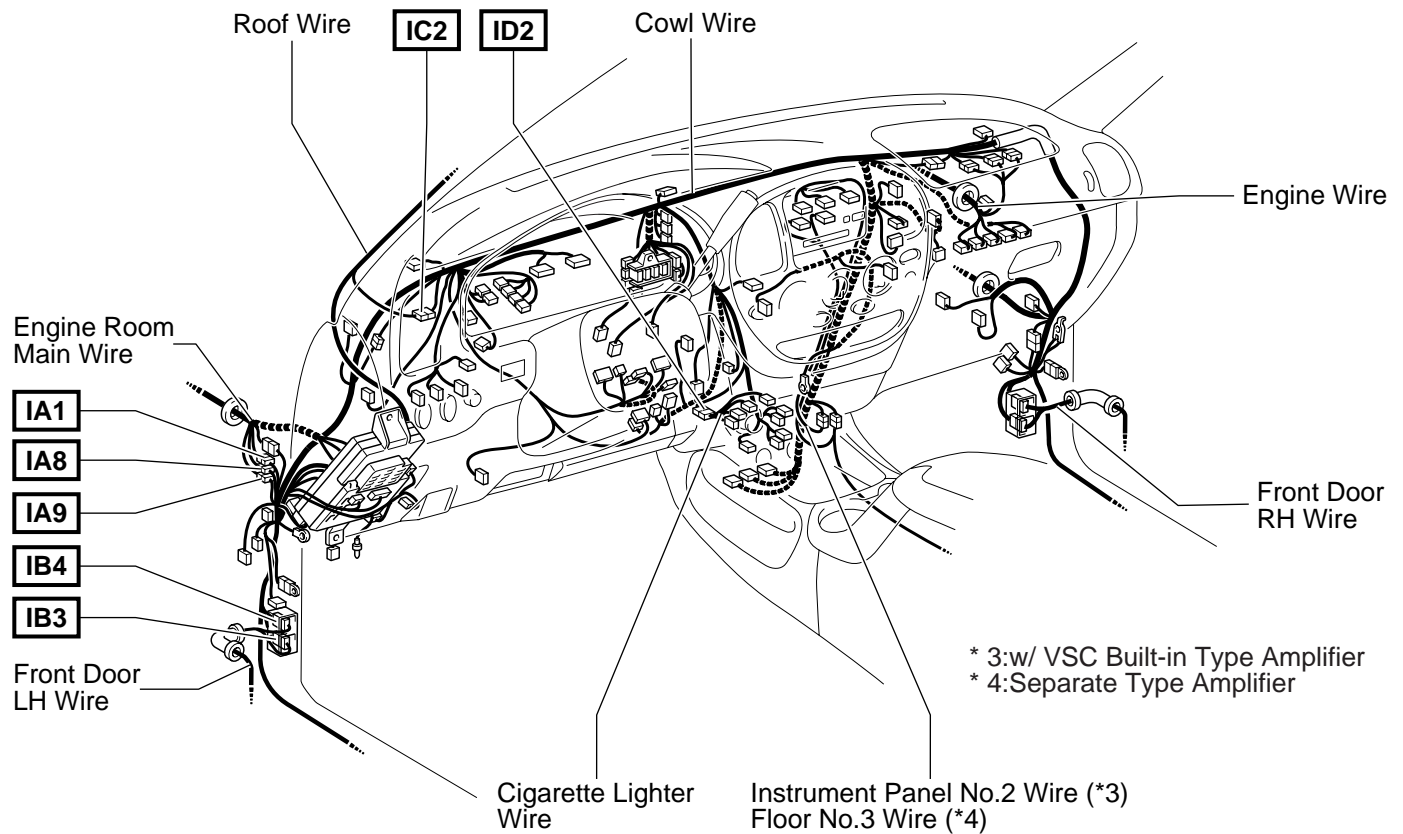

▽ : Location of Ground Points

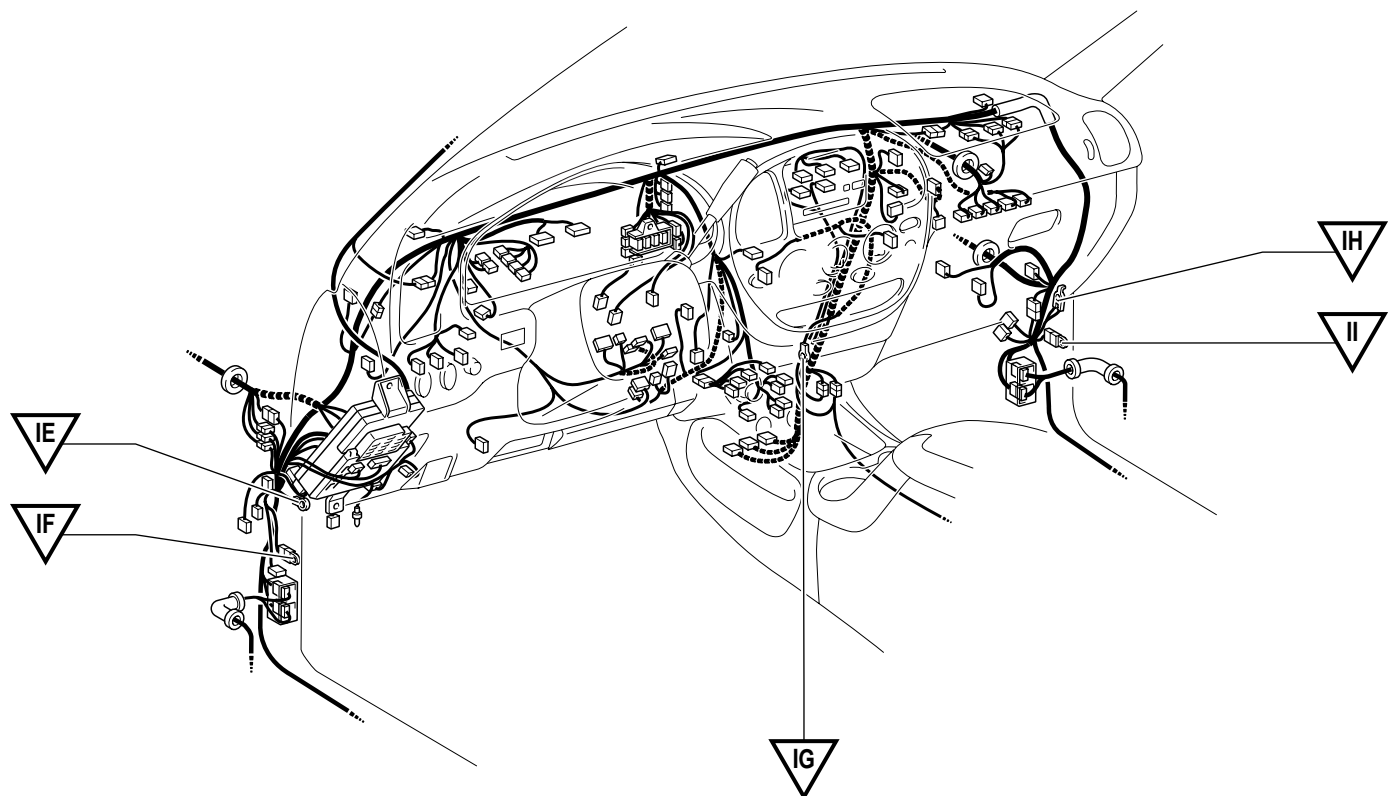

□ : Location of Connector Joining Wire Harness and Wire Harness  
 [Access Cab, Standard Cab]

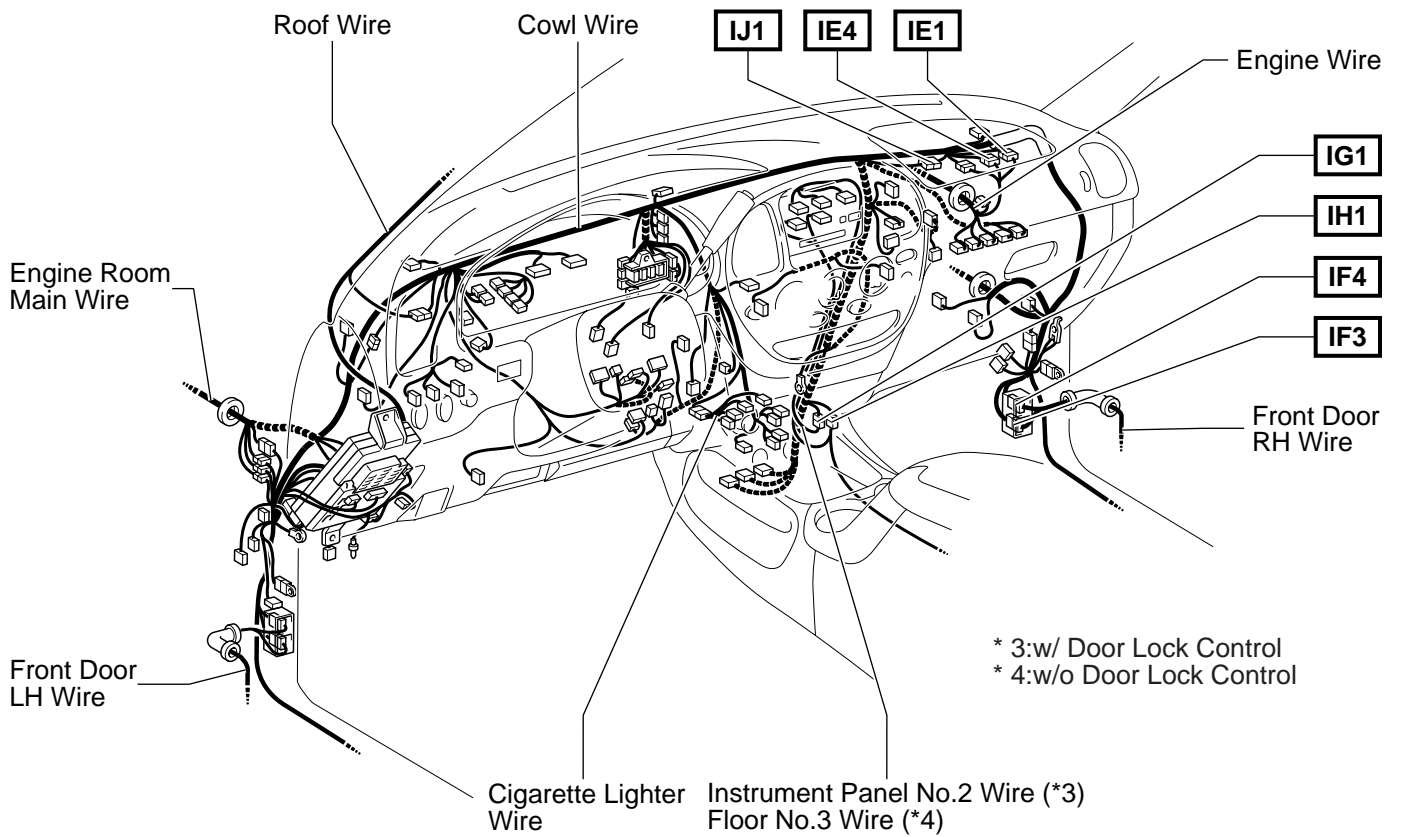

## G ELECTRICAL WIRING ROUTING

□ : Location of Connector Joining Wire Harness and Wire Harness

▽ : Location of Ground Points

[Access Cab]

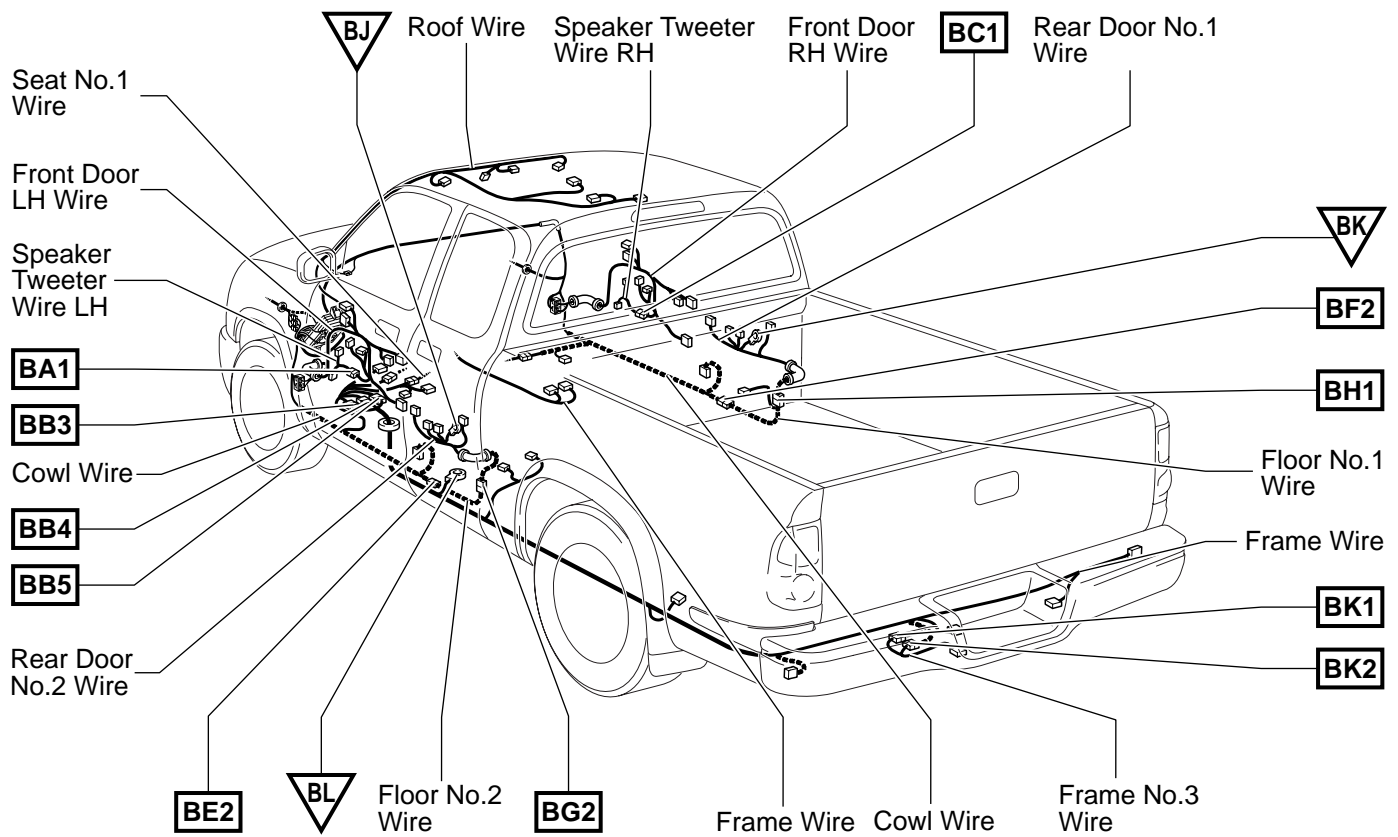

□ : Location of Connector Joining Wire Harness and Wire Harness

▽ : Location of Ground Points

[Standard Cab]

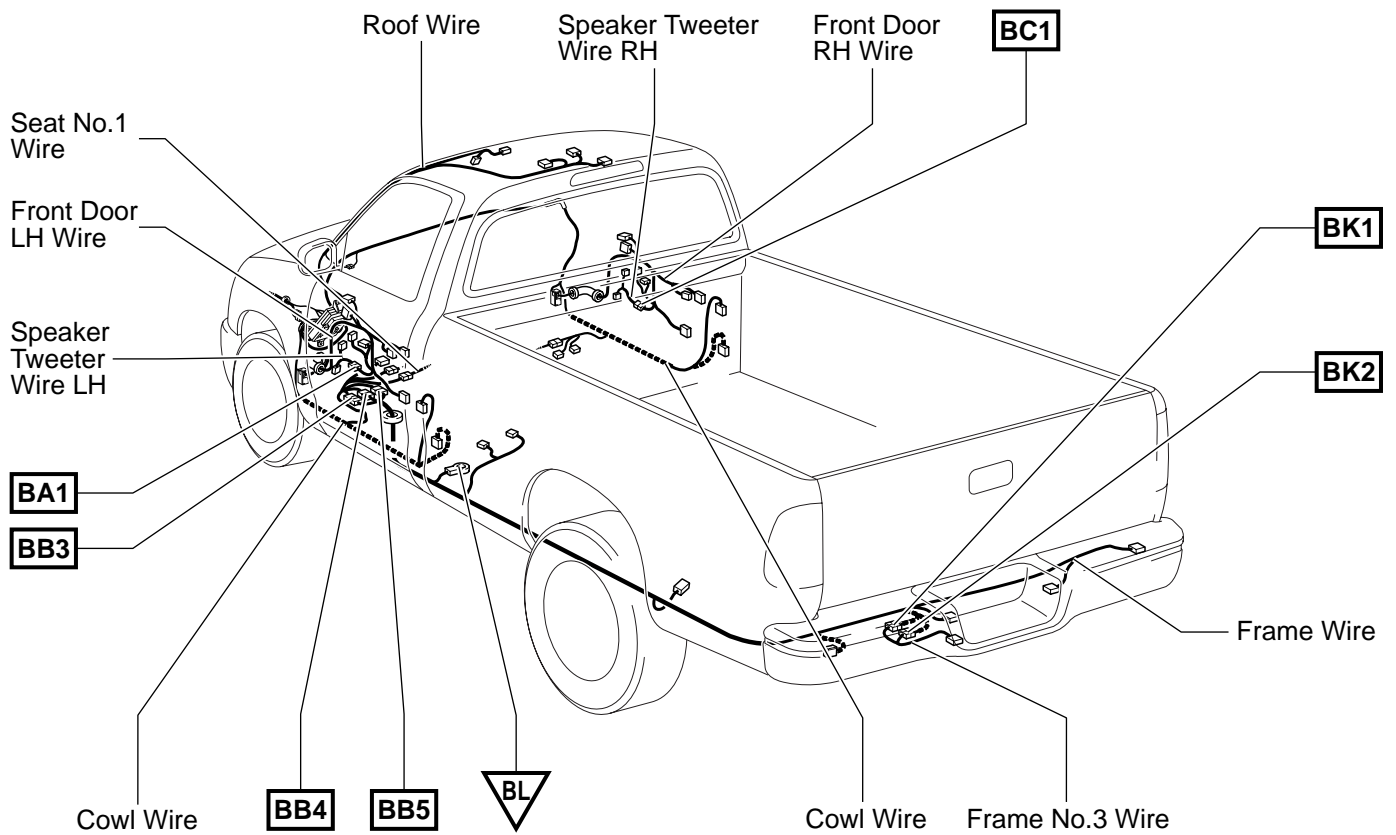

## G ELECTRICAL WIRING ROUTING

□ : Location of Connector Joining Wire Harness and Wire Harness

[Access Cab : Captain Seat]

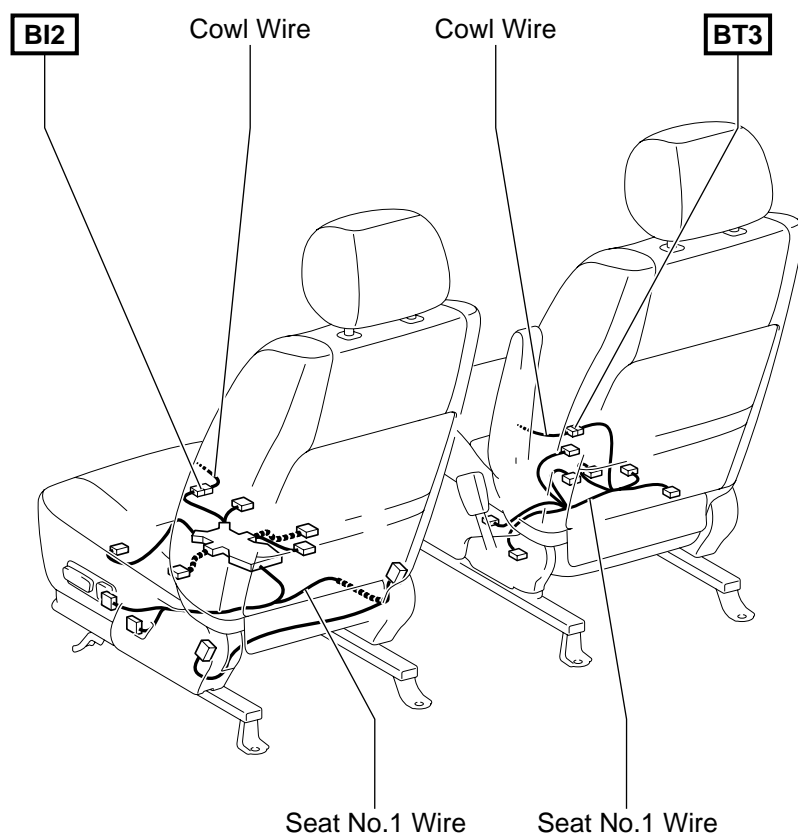

☐ : Location of Connector Joining Wire Harness and Wire Harness

[Access Cab : Separete Seat]

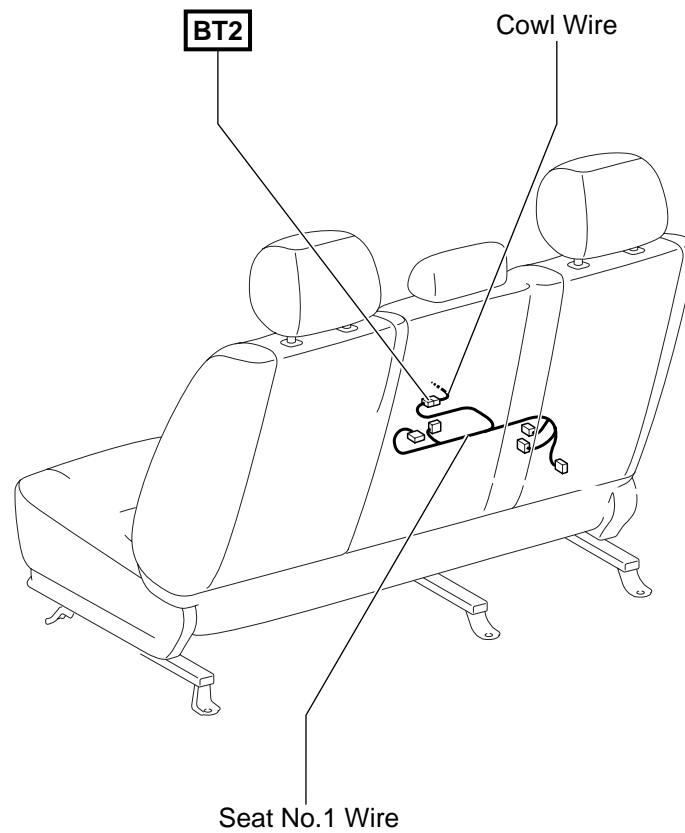



## G ELECTRICAL WIRING ROUTING

□ : Location of Connector Joining Wire Harness and Wire Harness

[Standard Cab : Bench Seat]

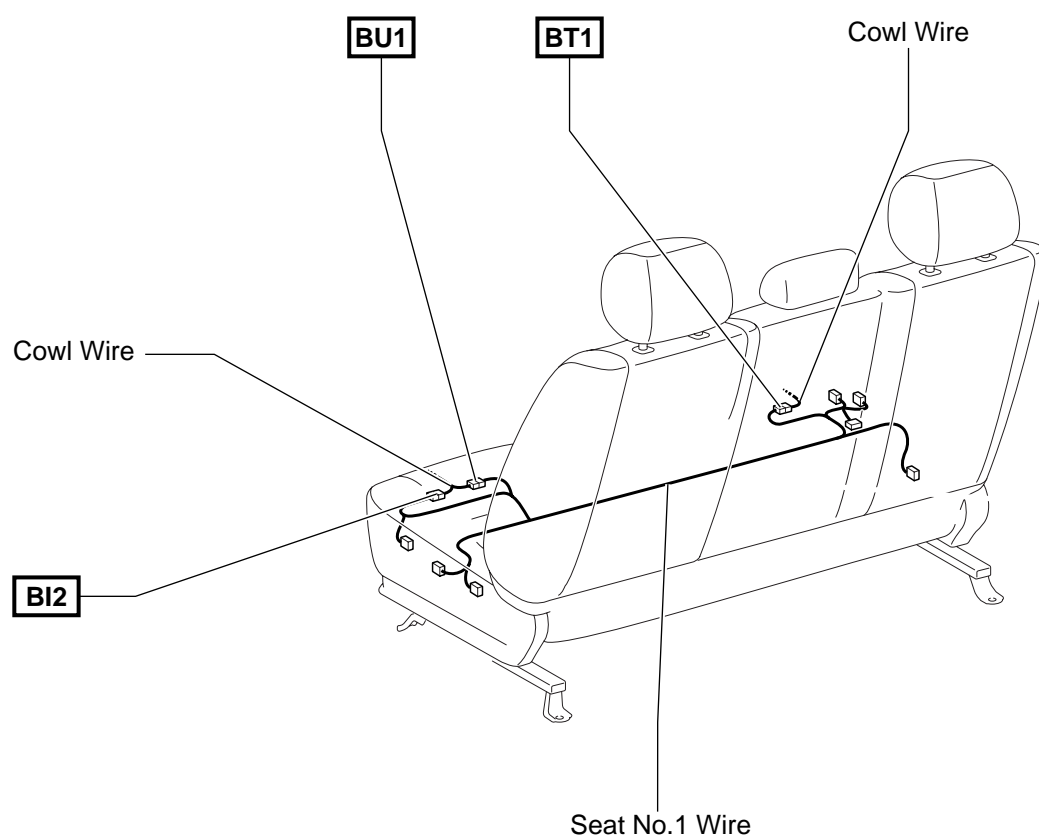



## G ELECTRICAL WIRING ROUTING

□ : Location of Connector Joining Wire Harness and Wire Harness

▽ : Location of Ground Points

[Double Cab]

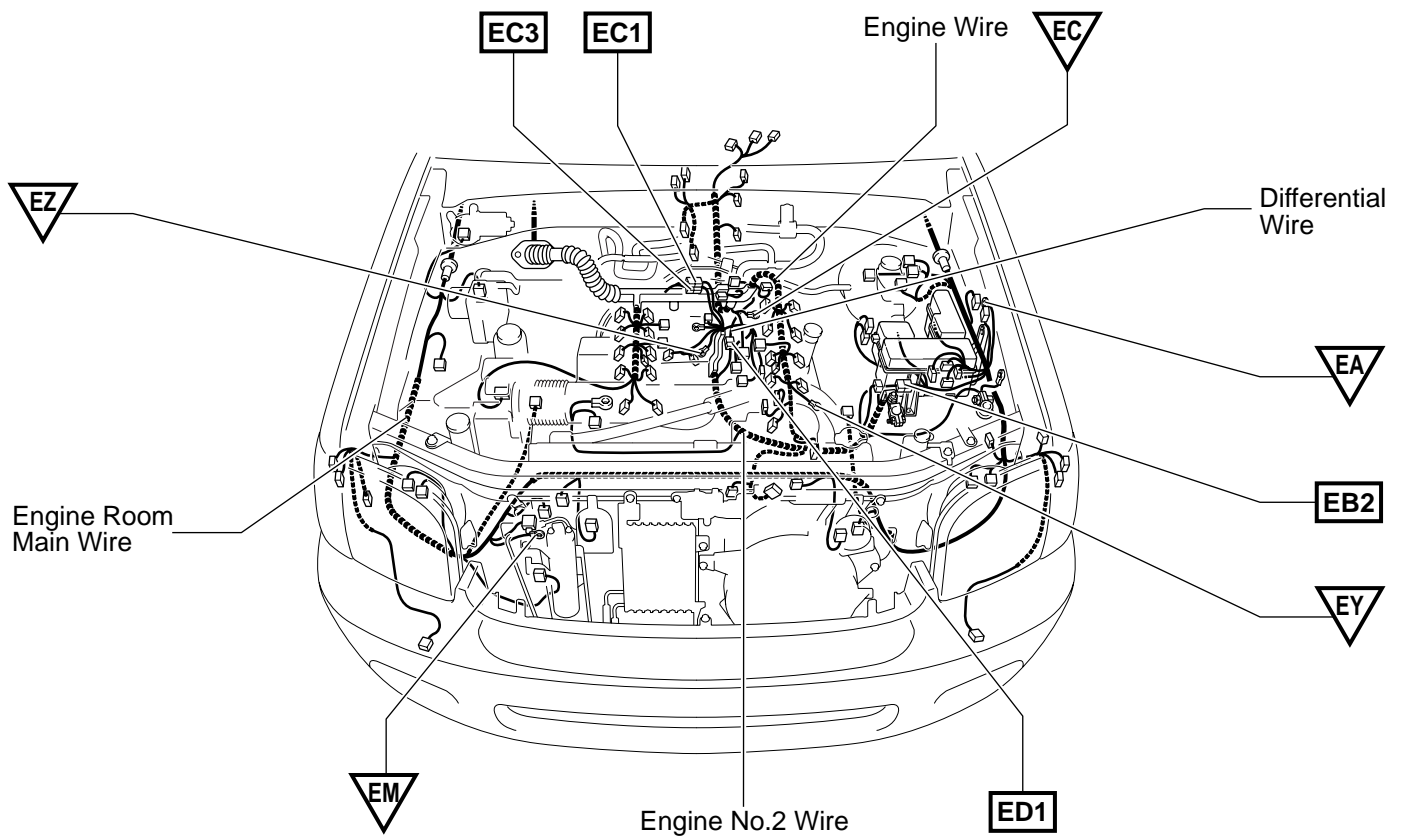



## G ELECTRICAL WIRING ROUTING

□ : Location of Connector Joining Wire Harness and Wire Harness

[Double Cab]

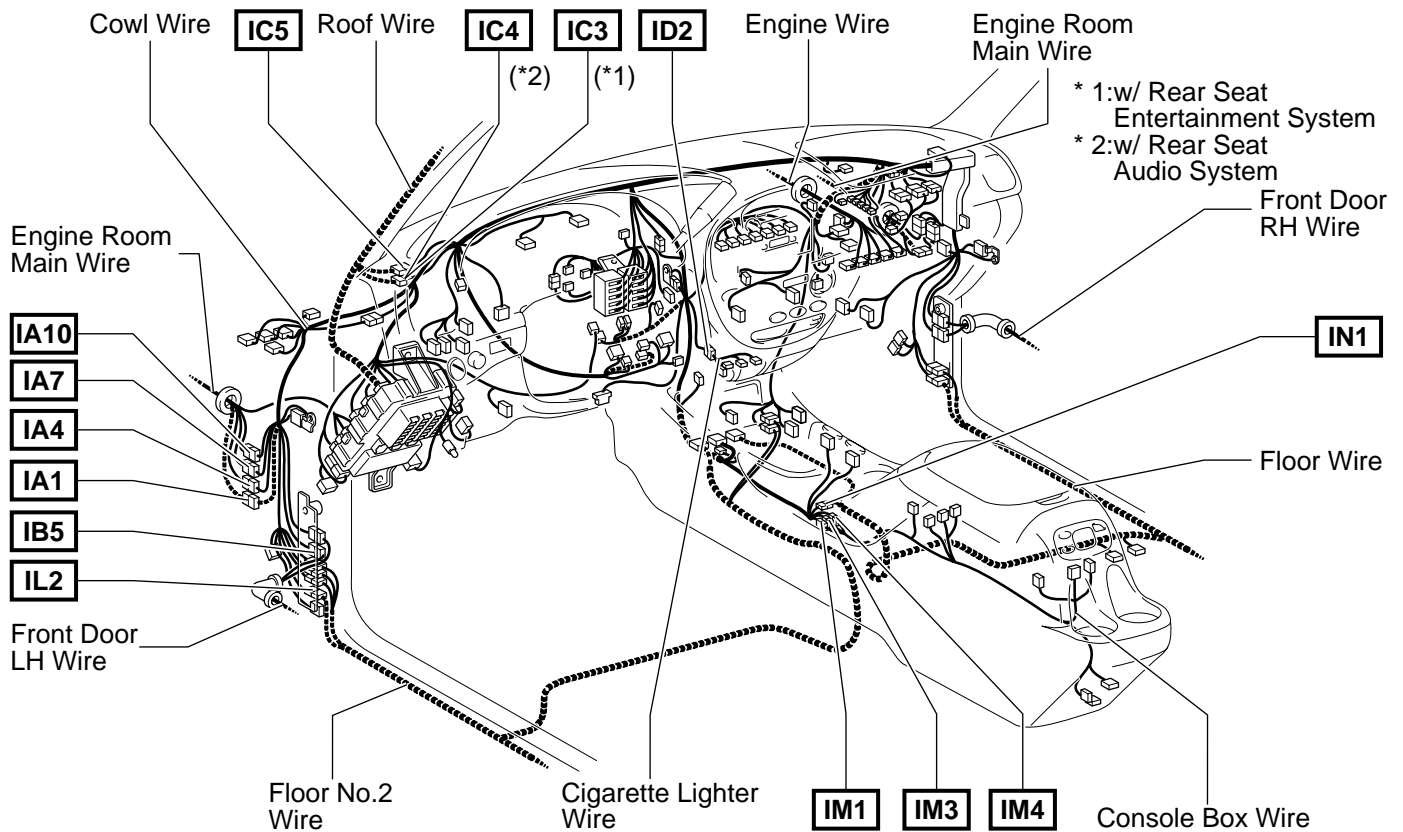

▽ : Location of Ground Points

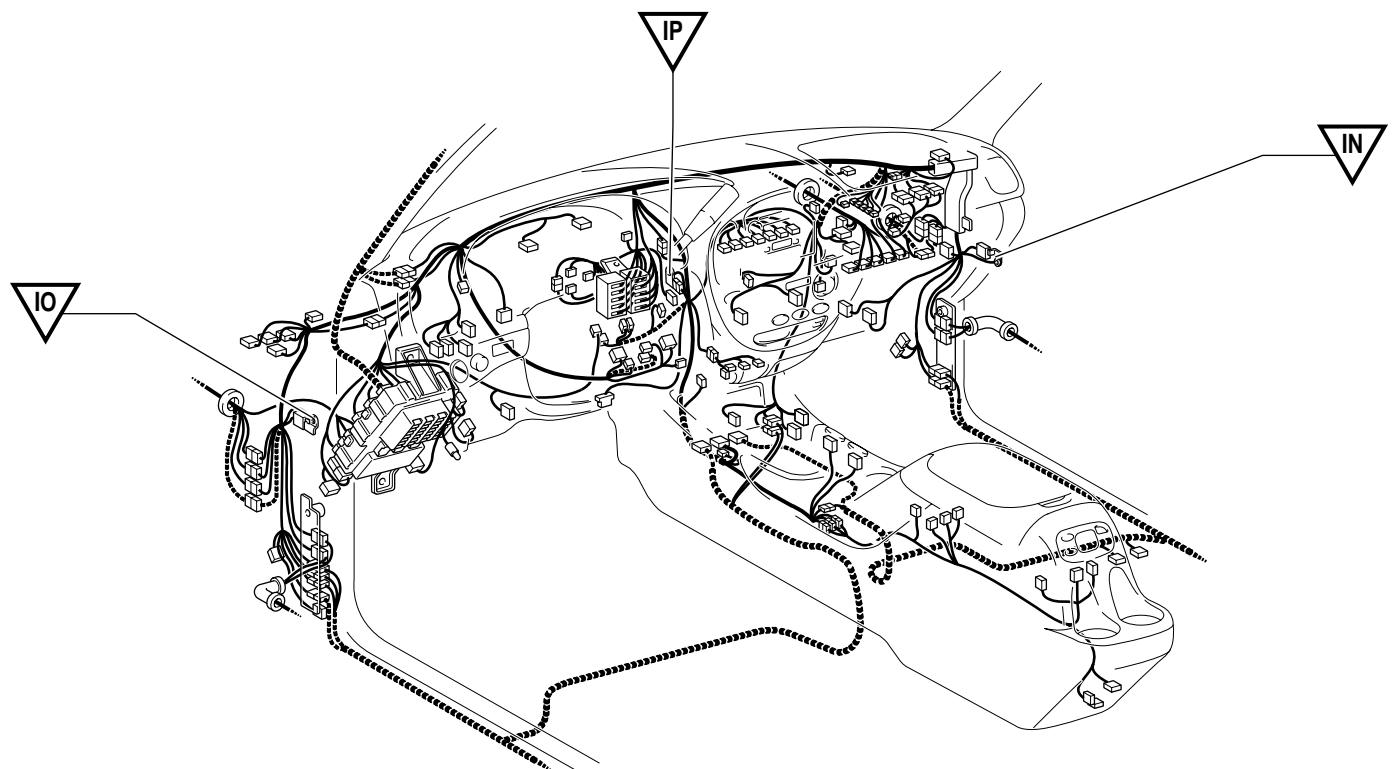

□ : Location of Connector Joining Wire Harness and Wire Harness

[Double Cab]

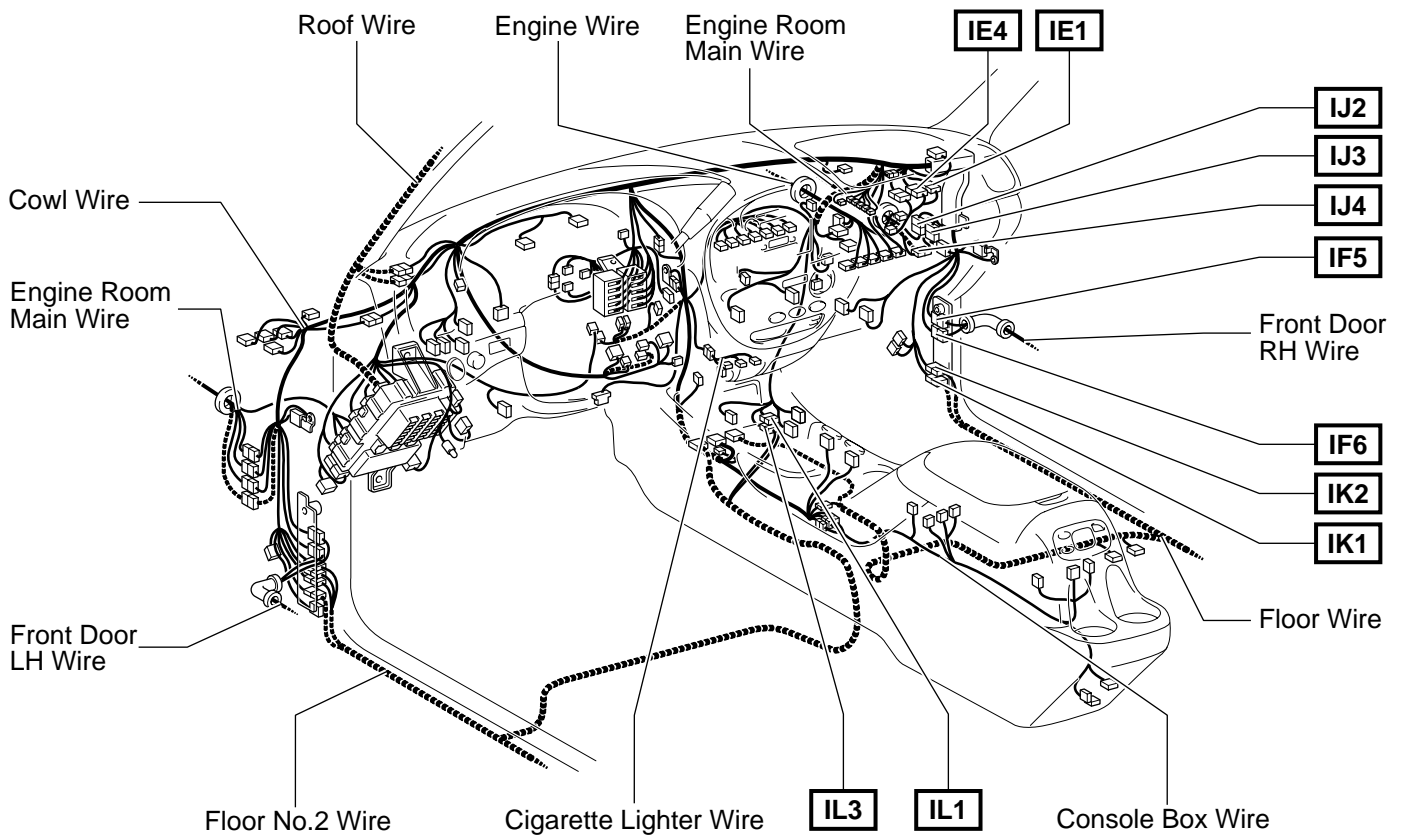

## G ELECTRICAL WIRING ROUTING

□ : Location of Connector Joining Wire Harness and Wire Harness

▽ : Location of Ground Points

[Double Cab]

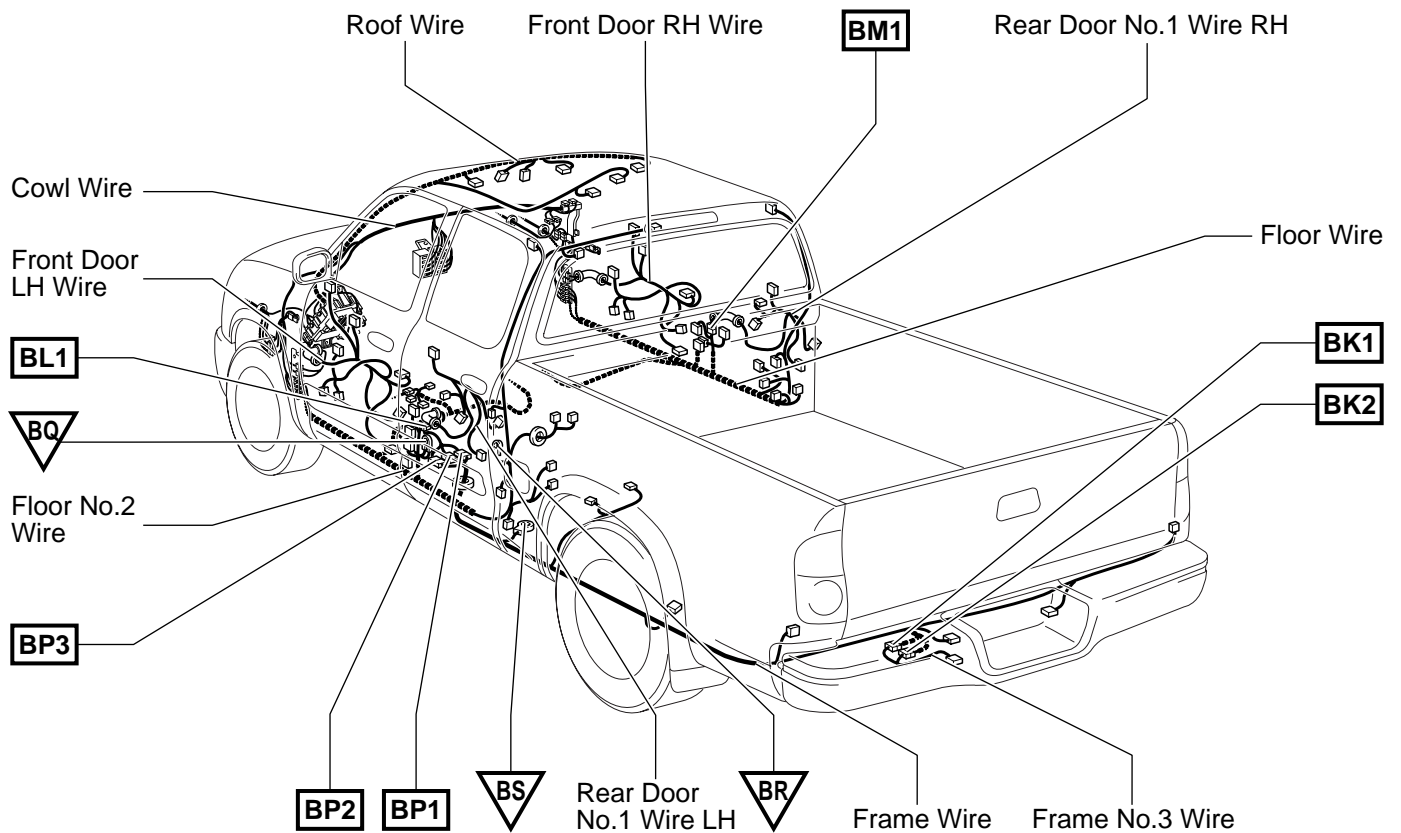





## G ELECTRICAL WIRING ROUTING

□ : Location of Connector Joining Wire Harness and Wire Harness

[Double Cab : Captain Seat]

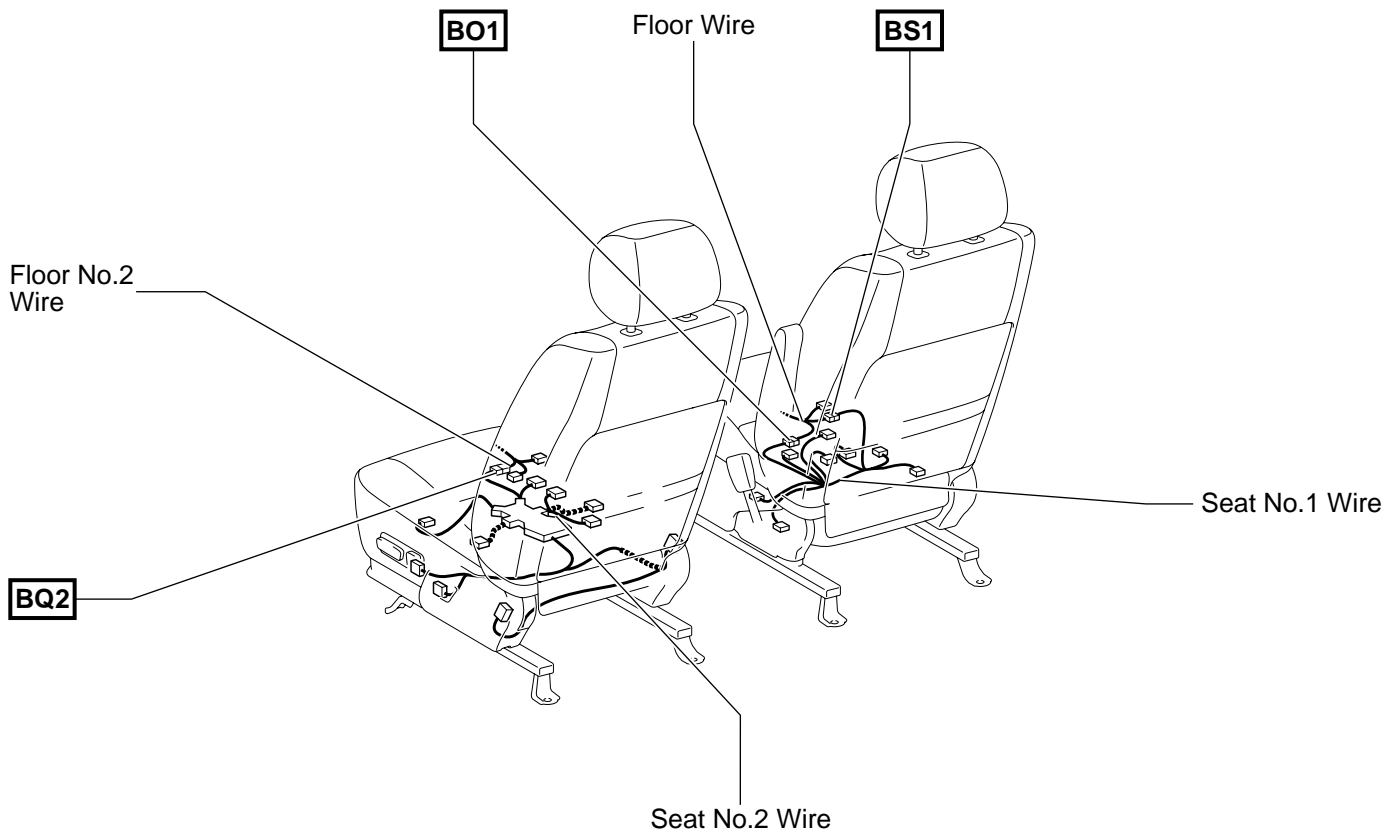

 : Location of Connector Joining Wire Harness and Wire Harness

[Double Cab : Separate Seat]

